

Steering (Group 6)

Buick used two types of steering linkages from 1961-1967, Saginaw & Thompson (Alternate). **Saginaw** original equipment can be identified by having a plastic plate, or a small "s" stamped on the plate. (see illustration A) Saginaw Idler arm assemblies will typically be a three-piece unit having a threaded steel bushing (see illustration B).. The Saginaw Idler Arm Assembly with the metal plug design is an integral unit with the bracket (see illustration C). Saginaw centerlinks have ball studs that measure .587 (see illustration D).. Saginaw linkage has straight joints (see Illustration E).

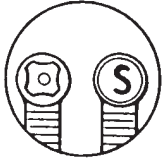

Illustration A

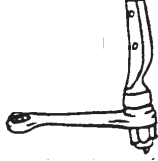

Illustration B



Illustration C

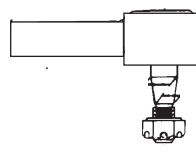

Illustration D

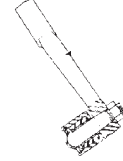

Illustration E

Thompson or **Alternate** original equipment can be identified by a plain metal cover plate under the ball stud of each socket (see illustration E). Thompson Idler Arm assemblies are a one piece unit (see illustration F). Thompson centerlinks have ball studs that measure .556 (see illustration G). Thompson linkage has tapered joints (see illustration H).

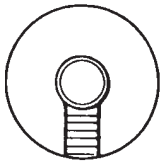

Illustration E

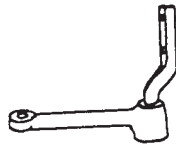

Illustration F

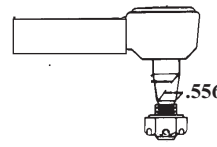

Illustration G

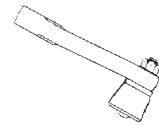
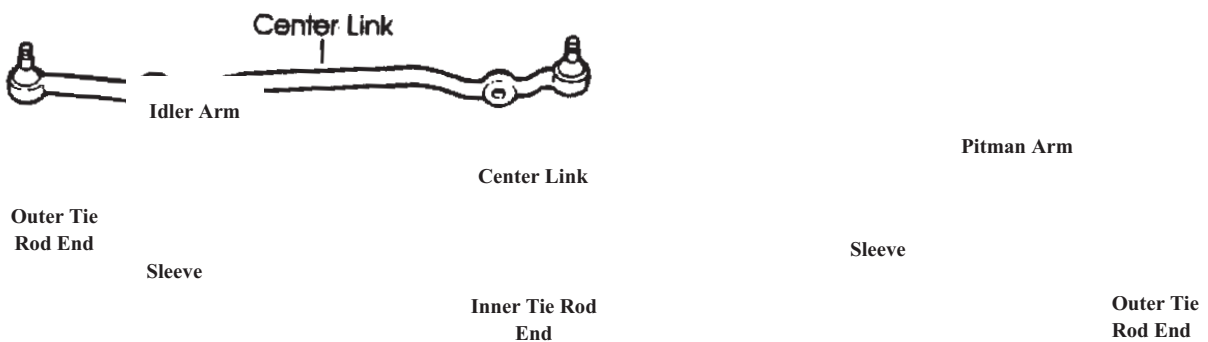
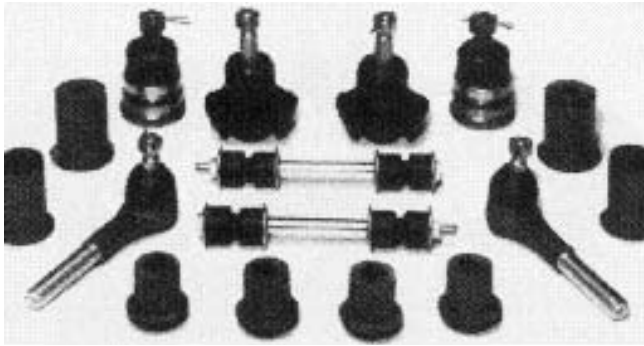

Illustration H



Standard Front End Rebuilding Kits



1961 thru 1972 Standard Kit Contains:

- 2 Upper Ball Joints
- 2 Lower ball Joints
- 2 Outer Tie Rod Ends
- Upper Inner Bushings
- Lower Inner Bushings
- 2 Stabilizer Repair Kits

1961 thru 1963 all. (state press-in or Screw-in Ball joints)

FEK-613S.....\$264.00 ea.

1964 thru 1972 all

FEK-642S.....\$155.25 ea.

1965-1966 Steering Wheels

Newreproduction wheel. paint to match

SW-656\$165.00 ea.

1969-1972 Steering

Wheels

This **BRAND NEW** reproduction wheel is identical to the original with correct diameter & grain detail. Does not include center cap.

SW-695.....\$159.00 ea.

SW-695K.(Wheel w/ WH-695 mounting hub).....\$249.00 ea.



1967-1972 Steering Wheel Cap

This cap will fit all 1967 thru 1972 3 spoke cushion grip or GSX wheels. It also fits 1967 thru 1969 wood style wheel. Cap includes emblem, black rubber cushion and brushed chrome bezel.

HC-675\$69.00 ea.

HE-675.....(plastic emblem only).....\$39.50 ea.

Deluxe Front End Rebuilding Kits

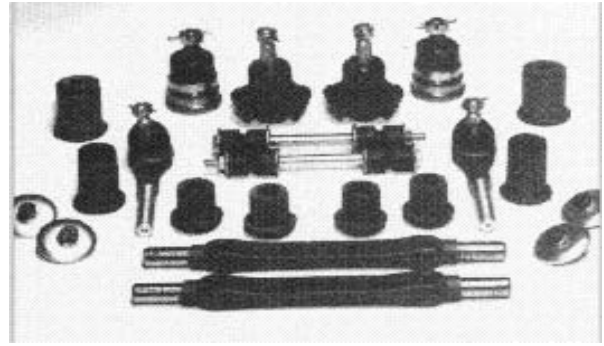

1961 thru 1972 Deluxe Kit Contains:

- 2 Upper Ball joints
- 2 Lower Ball Joints
- Inner Shaft Kits complete w/ Bushings
- 2 outer Tie Rod Ends
- 2 Stabilizer Repair Kits

1961 thru 1963 All..(state press-in or Screw-in Ball joints)

FEK-613D.....\$423.00 ea.

1964-1965 All

FEK-645D.....\$325.00 ea.

1966 thru 1970 All.

FEK-660D.....\$196.00 ea.

1971 thru 1972 All.

FEK-712D.....\$196.00 ea.

Steering Wheel Parts

1969-1972 Wheel Hub. For all cars with Rallye wheel.

WH-695\$59.50 ea.



1964-1966 Cancelling Cam. All except tilt wheel

CC-646.....\$24.50 ea.



1969-1972 Cancelling Cam for all exc. tilt wheel applications.

CC-694.....\$20.25 ea.

1966-1972 Horn spring and contact kit. For all standard wheels.

HS-666.....\$4.50 kit

1969-1972 Horn contact. For all cars with 3 spoke Rallye wheel.

HC-695\$27.50 ea.



Steering (Group 6)

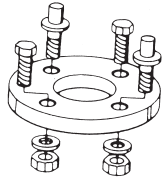

Steering Coupling Fiber Disc

1961-1972 All. Kit includes screws and nuts.
SD-570.....\$19.25 ea



Steering Couplers

1967-1969 All Regular Steering.
SC-679.....\$115.00 ea.
1970-1974 All Regular Steering
SC-704.....\$54.50 ea.

1967-1974 All with Power Steering.
SC-677.....\$62.00 ea.



Steering Flange (6.525)

1968-1970 All:
1971-1972 All 455 w/ Tilt Wheel
SF682.....\$38.00 ea.

Power Steering Pump Pulley

1967-1970 All:
5 3/8" diameter. Oem # 1386935
SP-670.....\$59.00 ea.



Steering Column Seals



1964 thru 1967 All.
SS-647.....\$6.50 ea.
1968 thru 1972 All.
SS-682.....\$6.50 ea.

Steering Column Jackets (6.578)



1964 thru 1967 All.
CJ-647.....\$21.50 ea.
1968 thru 1972 All.
CJ-692.....\$28.50 ea.

Power Steering Box Kits

1961 thru 1972 All.
SBK-610.....(Complete Seal Kit).....\$75.00 ea.

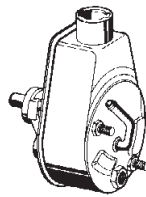
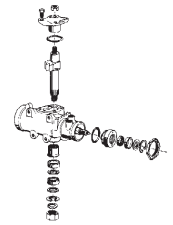

Steering Pump Rebuilding Service

1961-1972 All.
SPR-520.....\$169.50 ea.

Power Steering Pump Seal-Kits

1961 thru 1963 All.
SPK-613.....\$27.50 ea.
1964-1966 all 225, 300, 340, 400 engines.
SPK-596.....\$28.50 ea.
1967 thru 1972 all.
SPK-673.....\$19.50 ea.



Power Steering Pump Rebuilding Kits

1967 thru 1972 all.
SPK-679.....\$19.50 ea.

Pitman Arm

1968 thru 1972 All with power steering.
PA-682.....\$132.75 ea.

Pitman Shaft Seal Kit (6.855)

1961-1972 All.
PSK-577.....\$19.50 ea.

Power Steering Hoses

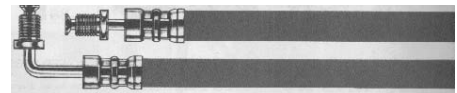

1964 thru 1969 all 225,300,350;
1967 GS 400 Pressure hose
SH-649P.....\$39.50 ea.
1964 thru 1969 all. Return line with fitting.
SH-592R.....\$14.50 ea.
1971 w/ 350 enging; 1972 all engines Pressure hose
SH-716P.....\$36.50 ea.

Steering (Group 6)

Idler Arms & Brackets (6.231)

- 1961-1962** Assembly.
- IA-612\$149.50 ea.
- 1963** Frame Bracket
- IA-63\$133.75 ea.
- 1964-1967**
- 1964:** All with 7/8" diameter centerlink;
- 1965-1967:** All.
- IA-647\$53.25 ea.
- 1964** All with 13/16" diameter centerlink;
- 1968-1972** All . For 13/16" centerlink.
- IA-682\$53.25 ea.



Centerlinks

- 1961-1972** Rebuilt with exchange.
- CLR-615\$185.50 ea.
- 1963** Rebuilt with exchange.
- CL-63S\$279.00 ea.
- 1964** All with with 13/16" diameter rod.
Sold outright
- CL-64.....\$89.00 ea.
- 1964** Late models with 7/8" diameter rod;
- 1965-1967** All . Sold outright.
- CL-647\$89.00 ea.
- 1968-1972** All sold outright.
- CL-682\$67.50 ea.

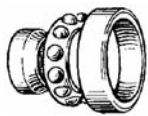

Front Wheel Bearings

(6.311)

- 1961 thru 1972** All. Inner
- IWB-612\$13.25 ea.
- 1961 thru 1972** All. Outer
- OWB-612.....\$10.00 ea.

Front Wheel Grease Seals

(6.326)



- 1961 thru 1963** All.
- GS-613.....\$10.75 ea.
- 1964 thru 1972** All.
- GS-642\$7.50 ea.

Front Wheel Grease Hub Caps

- 1961 thru 1970** All.
- HC-610\$12.50 ea.



Tie Rods & Ends



- 1961-1962** All outer ends. Two per car.
- TE-572\$43.50 ea.
- EC-372.....(Dust Cover)\$5.25 ea.
- 1961-1962** All Inner Tie Rods..
- TE-612L.....(L.H. Side).....\$81.00 ea.
- TE-612R.....(R.H. Side)\$81.00 ea.
- 1963** All outer ends. . Two per car.
- TE-63\$49.50 ea.
- 1963** All Inner Tie Rods..
- TE-63L.....(L.H. Side).....\$81.00 ea.
- TE-63R.....(R.H. Side)\$81.00 ea.
- 1964-1970** All outer ends. Two per car.
- TE-640\$35.25 ea.
- 1964-1970** All inner Tie Rods. Two per car.
- TE-640I.....\$42.25 ea.
- 1971-1972** All outer ends. . Two per car.
- TE-712\$43.50 ea.
- 1971-1972** All inner Tie Rods. Two per car.
- TE-712I.....\$43.50 ea.
- Tie Rod Adjusting Sleeves**
- 1961-1963** All. Two & Four per car.
- AS-506.....\$13.00 ea.
- 1964-1970** All. Two per car.
- AS-647\$12.75 ea.
- 1971-1972** All. Two per car.
- AS-506\$13.00 ea.

Front Suspension (Group 6)

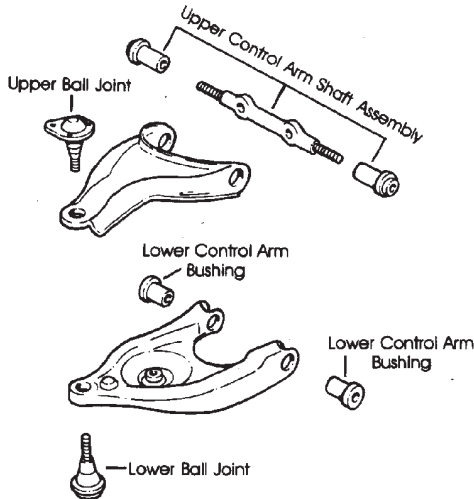

Ball Joints (6.169)

Lower

1961-1963 Screw in type.

LBJ-613S.....\$73.00 ea.

1961-1963 Press-in type.

LBJ-613P.....\$73.00 ea.

1964-1972

LBJ-644.....\$23.00 ea.

Upper (6.178)

1961-1962 All.

UBJ-612S.....\$52.00 ea.

1963 All.

UBJ-63.....\$73.75 ea.

1964-1972 All.

UBJ-642.....\$23.00 ea.

Front Stabilizer Bar Parts (7.240)

1961-1963 Stabilizer Repair Kit.

SK-615.....\$13.75 pr.

1964-1972 Stabilizer Repair Kit.

SK-572.....\$13.75 pr.



1967-1970 All. Stabilizer Link Bushing.
(8 needed per car).



SB-376.....\$1.00 ea.

Upper Control Arm Shaft Kits

(6.178)

CARS#:	YEARS:	APPLICATION:	PRICE:
UI-613S	1961-1963:	All.....	\$ 106.50 ea.
UI-645S	1964-1965:	All.....	\$ 129.50 ea.
UI-662S	1966-1972:	All.....	\$ 35.00 ea.
*UI-642	1964-1972:	All.....	\$ 68.25 kit

*UI-642 is a replacement kit referred to by the manufacturer as a "problem solver" that permits additional positive camber. This is particularly advantageous for cars with worn suspension. Includes shaft & bushings. Two kits needed per car.

Front Control Arm Bushings

Lower (6.169)

1961-1963 AllFront. Lower Kit. 2 pair needed per car.

LAB-613.....\$29.50 pr.

1964-1965: All Front & Rear Lower Kit. For one side.

LAB-645.....\$16.50 pr..

1966-1972 All Front Lower Kit. 2 pair needed per car.

LAB-662.....\$14.75 pr..

Upper (6.178)

1961-1963 AllFront. Upper Kit. 2 pair needed per car.

UAB-613.....\$29.50 pr.

1964-1965 AllFront. Upper Kit. 2 pair needed per car.

BK-645.....\$39.00 pr.

1966-1972 All Front Upper Kit. 2 pair needed per car.

UAB-662.....\$13.25 pr..

Control Arm Bumpers

CARS#: YEARS: APPLICATION: PRICE:

LB-612 1961-1972: Lower ~~~~~\$ 7.50

UB-612 1961-1972: All Upper ~~~~~\$ 9.50



1961-1962 Upper Control Arm Shaft support pin seals.

SS-376.....\$2.50 ea.

Stabilizer Bar To Frame Bushings (7.243)

1961-1963 All.

SB-593.....\$13.75 pr.

1964-1972 All with 15/16" bar or smaller.

SB-643.....\$8.25 pr.

1967-1972 All with 1" bar or larger.

SB-670.....\$8.25 pr.