

Electrical (Group 2)

Starter Rebuilding Service

Check NOS Section Group 2.041 for outright sales.

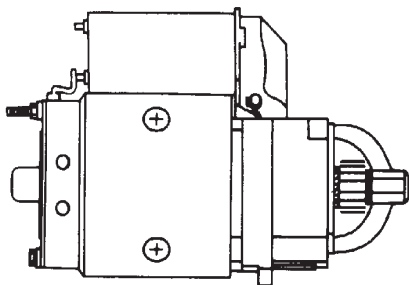

1961 All engines.	
S61	\$189.50 ea.
1962-1963 401, 425 engines.	
S623	\$189.50 ea.
1964-1966 401, 425 engines.	
S646RS.....(Rebuild)	\$189.50 ea.
1964-1967 300, 340 engines.	
S647RS.....(Rebuild)	\$189.50 ea.
1967-1974 All 400, 430, 455 engines.	
S674	\$129.50 ea.
1968-1974 All 350 engines.	
S684	\$119.50 ea.

Starter Drives



1961 All.	
SD571	\$49.50 ea.
1962-1963 All 401-425 engines.	
SD623	\$39.50 ea.
1964-1975 All engines.	
SD615.....	\$24.50 ea.



Starter Solenoids

1961-1975 All engines.	
SS575	\$53.00 ea.



Starter Brush Sets

1961-1974 All.	
SBS539.....	\$6.50 set



Starter Solenoid Repair Kits

1961-1975 All.	
SRK570.....	\$24.50 kit

Starter ID Tag

1963 Delco, starter and distributor ID tag.	
ET12.....	\$7.00 ea.



Wire and Cable Retainers

1963-1972 Engine compartment wiring strap. 7" long.	
WS5.....	\$1.50 ea.



1963-1972 Engine compartment wiring strap.	
WS6 2 3/4" Black.....	\$0.75 ea.
WS7 4" Black.....	\$0.75 ea.
WS8 4 1/2" Black.....	\$0.75 ea.
WS9 8 3/4" Black.....	\$0.75 ea.



1961-1966 Side frame rail wire retainers.	
WR616	\$5.00 ea.

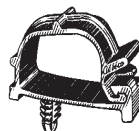

1967-1972 All. Retains positive battery cable to side frame rail.	
WR672.....	\$3.25 ea.

Ignition Switches

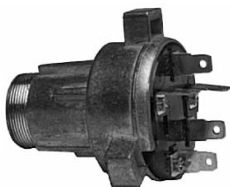

See NOS.....Section Group 2.188 for models not listed

Year	Cars No.	Price
1961-1962	All IS612	TOS
1964	All IS64	\$27.25 ea.
1965	All IS65	TOS
1966	All IS667	\$39.50 ea.
1969-1975	All with tilt wheel.	
	IS699T	\$29.50 ea.
1969-1975	All without tilt wheel.	
	IS699	\$29.50 ea.



Ignition Lock Cylinder with Keys



Year	Cars No.	Price
1961-1964	IL614	\$19.50 kit
1965	IL65	\$19.50 kit
1966-1967	IL667	\$19.50 kit
1968	IL68	\$19.50 kit
1969-1978	IL695	\$19.50 kit
1979-1991	IL791	\$19.50 kit



Key Blanks (Genuine GM)

We can also make keys from your code. Please inquire.

1961-1966 Door and Ignition - octagon.	
KB10.....	\$3.50 ea.
1961-1966 Glove and trunk - round.	
KB11.....	\$3.50 ea.
1967 & 1971 Door and Ignition - rectangular.	
KB48.....	\$3.50 ea.
1967 & 1971 Glove and trunk - oval.	
KB49.....	\$3.50 ea.
1968 & 1972 Door and ignition - rectangular.	
KB50.....	\$3.50 ea.
1968 & 1972 Glove and trunk - oval.	
KB51.....	\$3.50 ea.
1969 & 1973 Door and ignition - rectangular.	
KB44.....	\$3.50 ea.
1969 & 1973 Glove and trunk - oval.	
KB45.....	\$3.50 ea.
1970 Door and Ignition - rectangular.	
KB46.....	\$3.50 ea.
1970 Glove and trunk - oval.	
KB47.....	\$3.50 ea.
1974 Ignition - rectangular.	
KB46.....	\$3.50 ea.
1974 Glove, door and trunk - oval.	
KB47.....	\$3.50 ea.

1975 & 1979; 1983 & 1985 Ignition - rectangular.	
KB48.....	\$3.50 ea.
1975 & 1979; 1983 & 1985 glove, door and trunk - oval.	
KB49.....	\$3.50 ea.
1976 & 1980 Ignition - rectangular.	
KB50.....	\$3.50 ea.
1976 & 1980 Glove, door and trunk - oval.	
KB51.....	\$3.50 ea.
1977 & 1981 Ignition - rectangular.	
KB44.....	\$3.50 ea.
1977 & 1981 Glove, door and trunk - oval.	
KB45.....	\$3.50 ea.
1978 & 1982 Ignition - rectangular.	
KB46.....	\$3.50 ea.
1978 & 1982 Glove, door and trunk - oval.	
KB47.....	\$3.50 ea.



Key Caps



1967 thru 1985 All rectangular keys.	
KC670R.....	\$1.50 ea.
1967 thru 1985 All oval keys.	
KC670O.....	\$1.50 ea.

Electrical (Group 2)

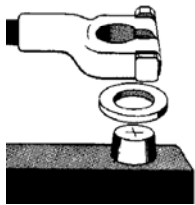

Battery Terminal Protectors

Stops corrosion indefinitely. Two protectors in each kit.

BW300.....\$3.75 kit

Battery Cable End Covers

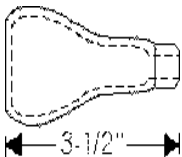

1963-1975 Battery terminal cable cover. 2 per car.

CC315.....\$6.25 ea.

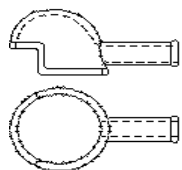

1963-1975 (+) Terminal and junction block cable cover.

CC325.....\$6.25 ea.

Battery Cables

Our **battery cables** listed below for **TOP POST** batteries are made with heavy duty two (2) gauge copper wire.



Wire Loom



Asphalt coated fabric. Wire loom for battery cables, headlamps, wire etc.

WL180	1/8" ID	\$1.85 ft.
WL316	3/16" ID	\$1.85 ft.
WL140	1/4" ID	\$2.10 ft.
WL516	5/16" ID	\$2.10 ft.
WL380	3/8" ID	\$2.10 ft.
WL716	7/16" ID	\$2.10 ft.
WL120	1/2" ID	\$2.10 ft.
WL916	9/16" ID	\$2.40 ft.
WL580	5/8" ID	\$2.40 ft.
WL340	3/4" ID	\$2.40 ft.

Our reproduction "**Spring Ring**" cables are made from GM blueprints to be identical to the originals in fit and functions. They are sold in pairs. "Spring Ring" cables are also sold individually. **Inquire!**

Years	Replacement Cables				Spring Ring	Switch to Starter	
	(+) Positive	Price	(-) Negative	Price			
1961.....	BC24	\$19.50 ea	BC24.....	\$19.50 ea.	INQUIRE		
1962.....	BC17	\$16.50 ea	BC19.....	\$17.50 ea.			
1963.....	BC31	\$25.25 ea	BC17.....	\$16.50 ea		SC32.....	\$27.75 ea
1964 Wildcat, Electra.....	BC31	\$25.25 ea	BC24.....	\$19.50 ea		SC32.....	\$27.75 ea
1964-1967 LeSabre.....	BC48	\$34.50 ea	BC31.....	\$25.25 ea			
1965 Wild., Elec. w/ P.S.	BC38	\$27.25 ea	BC24.....	\$19.50 ea		SC32.....	\$27.75 ea
1965 Wild., Elec. w/o P.S.	BC38	\$27.25 ea	BC31.....	\$25.25 ea		SC32.....	\$27.75 ea
1966 Wildcat, Electra.....	BC38	\$27.25 ea	BC31.....	\$25.25 ea		SC32.....	\$27.75 ea
1967-1968 Wild., Elec.	BC53	\$33.50 ea	BC31.....	\$25.25 ea			
1968 LeSabre	BC42	\$30.25 ea	BC31.....	\$25.25 ea			
1969-1970 LeSabre.....	BC48	\$34.50 ea	BC31.....	\$25.25 ea			
1969-1970 Wildcat, Elec.....	BC53	\$33.50 ea	BC31.....	\$25.25 ea			
1971-1972 LeSabre.....	BC42	\$30.25 ea	BC31.....	\$25.25 ea			
1971-1972 W/C, Elec. Cent....	BC48	\$34.50 ea	BC31.....	\$25.25 ea			



Battery Clamps (2.341)

1961-1967 Clamps are rubber coated as original.



1961-1962 All.
BC602\$39.50 ea.



1963 All.
BC635\$27.50 ea.



1965-1966 All.
BC657\$26.50 ea.



1967 All.
BC670\$26.50 ea.



1968-1975 All. Clamp Only.
BC682.....\$3.00 ea.



Bolt only.
BB682.....\$2.25 ea.

Battery Bolts



1961-1962 All. Two per car needed. Cut to length if necessary. Includes washer and wing nut.
BB602.....\$6.50 ea.



1963-1964 All. Cut to length if necessary. Includes washer and nut.
BB635.....\$6.00 ea.



1965-1967 All. Includes washer and nut.
BB610.....\$6.75 ea.



www.oldbuickparts.com
908-369-3666

Your Buick is mighty
"Choosey" about the
company it keeps.....

Treat it to the Best
Use only Cars Quality
Original, Reproduction
and Used Parts

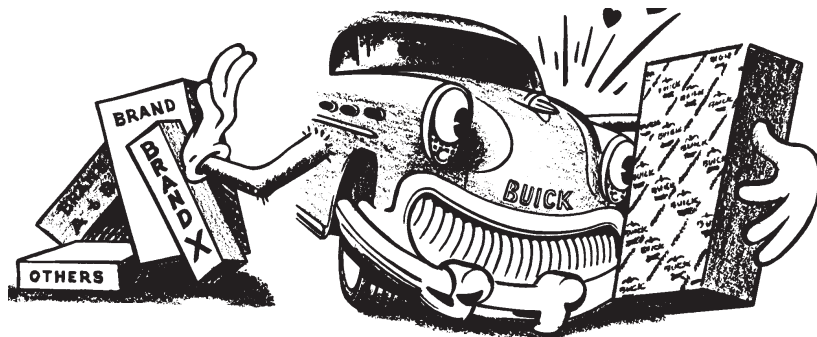

1961-1974 Buick Date Coded Spark Plug Wires

For those requiring the best for their show ready car, these reproduction wire sets are unsurpassed. They are manufactured to original GM blueprint specifications. They include the proper boots, terminals, script and correct factory length. All wires are carbon core for radio suppression. They come correctly identified with "**Packard Radio TVRS**" or "**Radio GM**" along with the proper date code to match your car.

Date codes will read as such: 3 Q 67. The first number, "3" corresponds to the third quarter of the year. "Q" means quarter. The last number, "67", is the year, 1967. Thus, a cable marked 3 Q 67 was produced in the third quarter of 1967. You should order your spark plug wire sets with dates that are 6 to 12 months prior to the manufacturing date of your car. *Note:* wires were not dated on vehicles prior to January 1961.

Reproduction Spark Plug Wire Sets - 8 Cylinder

PART NO.	DATE	YEAR	DESCRIPTION	PRICE
W3322611	1-Q-61	1961	Spark Plug Wires, V8 All	\$79.50 set
W3330613	3-Q-61	1962	Spark Plug Wires, V8 All	\$79.50 set
W3330621	1-Q-62	1962	Spark Plug Wires, V8 All	\$79.50 set
W3330623	3-Q-62	1963	Spark Plug Wires, V8 All	\$79.50 set
W3330631	1-Q-63	1963	Spark Plug Wires, V8 All	\$79.50 set
W3334633	3-Q-63	1964	Spark Plug Wires, V8 All 300C.I.	\$79.50 set
W3334641	1-Q-64	1964	Spark Plug Wires, V8 All 300C.I.	\$79.50 set
W3330633	3-Q-63	1964	Spark Plug Wires, V8 All 404 & 425 C.I.	\$79.50 set
W3330641	1-Q-64	1964	Spark Plug Wires, V8 All 404 & 425 C.I.	\$79.50 set
W3334643	3-Q-64	1965	Spark Plug Wires, V8 All 300C.I.	\$79.50 set
W3334651	1-Q-65	1965	Spark Plug Wires, V8 All 300C.I.	\$79.50 set
W3330643	3-Q-64	1965	Spark Plug Wires, V8 All 404 & 425 C.I.	\$79.50 set
W3330651	1-Q-65	1965	Spark Plug Wires, V8 All 404 & 425 C.I.	\$79.50 set
W3334653	3-Q-65	1966	Spark Plug Wires, V8 All 340C.I.	\$79.50 set
W3334661	1-Q-66	1966	Spark Plug Wires, V8 All 340C.I.	\$79.50 set
W3332653	3-Q-65	1966	Spark Plug Wires, V8 All 401 & 425 C.I.	\$79.50 set
W3332661	1-Q-66	1966	Spark Plug Wires, V8 All 401 & 425 C.I.	\$79.50 set
W3338663	3-Q-66	1967	Spark Plug Wires, V8 All 350 C.I.	\$79.50 set
W3338671	1-Q-67	1967	Spark Plug Wires, V8 All 350 C.I.	\$79.50 set
W3342663	3-Q-66	1967	Spark Plug Wires, V8 All 400, 430 C.I.	\$79.50 set
W3342671	1-Q-67	1967	Spark Plug Wires, V8 All 400, 430 C.I.	\$79.50 set
W3338673	3-Q-68	1968	Spark Plug Wires, V8 All 350 C.I.	\$79.50 set
W3338681	1-Q-68	1968	Spark Plug Wires, V8 All 350 C.I.	\$79.50 set
W3342673	3-Q-67	1968	Spark Plug Wires, V8 All 400, 430 C.I.	\$79.50 set
W3342681	1-Q-68	1968	Spark Plug Wires, V8 All 400, 430 C.I.	\$79.50 set
W3338683	3-Q-68	1969	Spark Plug Wires, V8 All 350 C.I.	\$79.50 set
W3338691	1-Q-69	1969	Spark Plug Wires, V8 All 350 C.I.	\$79.50 set
W3342683	3-Q-68	1969	Spark Plug Wires, V8 All 400, 430 C.I.	\$79.50 set
W3342691	1-Q-69	1969	Spark Plug Wires, V8 All 400, 430 C.I.	\$79.50 set
W3338693	3-Q-69	1970	Spark Plug Wires, V8 All 350 C.I.	\$79.50 set
W3338701	1-Q-70	1970	Spark Plug Wires, V8 All 350 C.I.	\$82.50 set
W3342693	3-Q-69	1970	Spark Plug Wires, V8 All 455 C.I.	\$79.50 set
W3342701	1-Q-70	1970	Spark Plug Wires, V8 All 455 C.I.	\$79.50 set

Continued from previous page...

PART NO.	DATE	YEAR	DESCRIPTION	PRICE
W3338703	3-Q-70	1971	Spark Plug Wires, V8 All 350 C.I.	\$79.50 set
W3338711	1-Q-71	1971	Spark Plug Wires, V8 All 350 C.I.	\$79.50 set
W3342703	3-Q-70	1971	Spark Plug Wires, V8 All 455 C.I.	\$79.50 set
W3342711	1-Q-71	1971	Spark Plug Wires, V8 All 455 C.I.	\$79.50 set
W3340713	3-Q-71	1972	Spark Plug Wires, V8 All 350 C.I.	\$79.50 set
W3340721	1-Q-72	1972	Spark Plug Wires, V8 All 350 C.I.	\$79.50 set
W3344713	3-Q-71	1972	Spark Plug Wires, V8 All 455 C.I.	\$79.50 set
W3344721	1-Q-72	1972	Spark Plug Wires, V8 All 455 C.I.	\$79.50 set
W3340723	3-Q-72	1973	Spark Plug Wires, V8 All 350 C.I.	\$79.50 set
W3340731	1-Q-73	1973	Spark Plug Wires, V8 All 350 C.I.	\$79.50 set
W3344723	3-Q-72	1973	Spark Plug Wires, V8 All 455 C.I.	\$79.50 set
W3344731	1-Q-73	1973	Spark Plug Wires, V8 All 455 C.I.	\$79.50 set
W3340733	3-Q-73	1974	Spark Plug Wires, V8 All 350 C.I.	\$79.50 set
W3340741	1-Q-74	1974	Spark Plug Wires, V8 All 350 C.I. EXC HEI	\$79.50 set
W3344733	3-Q-73	1974	Spark Plug Wires, V8 All 350 C.I. EXC HEI	\$79.50 set
W3344741	1-Q-74	1974	Spark Plug Wires, V8 All 455 C.I. EXC HEI	\$79.50 set

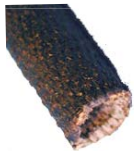

Wire Loom

Asphalt coated fabric. Wire loom for battery cables, headl-amps, wire etc.

WL180	1/8" ID	\$1.55 ft.
WL316	3/16" ID	\$1.55 ft.
WL140	1/4" ID	\$1.80 ft.
WL516	5/16" ID	\$1.80 ft.
WL380	3/8" ID	\$1.80 ft.
WL716	7/16" ID	\$1.80 ft.
WL120	1/2" ID	\$1.80 ft.
WL916	9/16" ID	\$2.15 ft.
WL580	5/8" ID	\$2.15 ft.
WL340	3/4" ID	\$2.15 ft.

Nylon Wire Loom



NWL140	1/4" ID x 1 ft. length	\$1.50
NWL380	3/8" ID x 5 ft. length	\$6.50
NWL120	1/2" ID x 4 ft. length	\$6.00
NWL340	3/4" ID x 1 ft. length	\$1.75

Wiring Harness Tape



Non-adhesive vinyl harness wrap is same as used by GM. 1" wide, 100 foot roll.

WT1001" wide.....\$11.25 roll

Spark Plug Wire Retainers



1963-1966 Ignition wire retainer (on rocker covers). Two per car.
WR596.....\$4.25 ea.



1968-1973 All. Ignition wire retainer. Two per car.
WR683.....\$4.00 ea.



1967-1973 All. Ignition "3" wire retainers. Two per car.
WR673\$4.00 ea.



www.oldbuickparts.com
908-369-3666

Electrical (Group 2)

Complete Tune-up Kit

1961-1975 Complete tune-up kit. Includes: replacement spark plugs, ignition wires, points rotor, condenser and cap.
TK579\$79.75 kit

Replacement Tune-up Parts (2.384)



1961-1974 Ignition points.
D106\$16.50 ea.

1961-1974 Combination ignition points and condenser.
IPC573.....\$14.50 ea.



1961-1974 Distributor Cap.
D308.....\$13.50 ea.
D308R.....("Delco Remy" Repro).....\$51.75 ea.

1961-1974 Distributor Rotor.
D409\$7.50 ea.



1961-1966: All.
IW576\$29.50 ea.
1967-1974: All V-8; 1974: All V-8 except HEI.
IW674\$23.75 ea.

Condensers



1964-1966
1964-1965: 300 engines;
1966: 340 engine with side adjust window.
D203\$6.00 ea.

1961-1974
1961-1965: 364, 401, 425 engines;
1966: 340 engines with front adjust window;
1967-1974: All.
D204\$6.00 ea.

Ignition Coils



1963-1974 All. Replacement ignition coil.
IC539.....\$26.50 ea.



1963-1974 Delco ignition coil.
IC539D\$58.00 ea.

1961-1972 Ignition coil resistor
CR533.....\$11.50 ea.



Distributor Adjusting Tool

1961-1974 All.
DT575\$10.00 ea.



Universal Coil Bracket
CB350.....\$6.50 ea.
CB350C.....Chrome.....\$11.50 ea.

Spark Plugs



1961-1967 All exc. 1964 with 300.
SPR43S\$2.95 ea.
1964 300 engine.
SPR43FS\$2.95 ea.
1965-1967 300, 340 engines with 2 BBL carb.
SP45R.....\$2.95 ea.
1967-1971 400, 430 and 455 engines.
SP44TS\$2.95 ea.

1968-1974
1968-1971: 350 engines;
1972-1974: All.
SP45TS.....\$2.95 ea.

Ignition Wire Sets



1961-1966 All.
IW576.....\$29.50 set
1967 300 and 340 engines. Delco
IW667D.....\$36.75 set
1967-1976
1967: 430 engines;
1968-1976: All V-8 engines. Delco
IW672D.....\$42.50 set
1964-1969 6 cylinder cars
1964-1967: All;
1968-1969: with air conditioning. Delco
IW629D.....\$36.75 set

See page 24 and 25 for date coded wire sets



1961-1967 Spark plug rubber boot. For use with original type copper core ignition wires.
SB577\$3.00 ea.

Voltage Regulators



1961-1962 Generator voltage regulator for cars with air conditioning.
VR582A\$69.50 ea.
1961-1962 Generator voltage regulator for cars without air conditioning.
VR572\$59.50 ea.
1962-1972 All except H. D. 62 and 80 amp. Delco voltage regulator for alternator.
VR622\$19.75 ea.
VR622D.....Genuine Delco\$79.50 ea.
VR622E.....Electronic Replacement\$49.50 ea.
1965-1975 All with heavy duty 62-80 AMP alternators.
VR655.....\$19.75 ea.



www.oldbuickparts.com

Never Change Points Again!

Upgrade to an electronic ignition. Fits entirely inside the distributor.

Installs as quickly as changing a set of points. No black boxes, complicated wiring or special brackets. Only two wires to connect.

IGNITOR ELECTRONIC IGNITION KITS	NO.	PRICE
---	------------	--------------

8 CYLINDER

1937-1953 All Straight 8, 6 volt, negative ground	PI1183N6	\$119.75
1937-1953 All Straight 8, 12 volt, negative ground (original distributor)	PI1183	\$109.25
1953-1956 All V-8 Mechanical advance under baseplate	PI1185LS	\$89.50
1957-1974 All V-8 Except 215, 300, 340 Engines	PI1181LS	\$89.50
1957-1974 All V-8	PI1181	\$89.50
1957-1974 All V-8 (Ignitor II)	PI91181	\$109.50

6 CYLINDER

1968-1974 All	PI1162A	\$89.50
1962-1967 V-6 Engine	PI1164	\$89.50
1962-1967 V-6 Engine (Odd Fire)	PI1165	\$89.00

HIGH PERFORMANCE COIL

1937-1953 All Straight 8, 6 volt, negative ground (Black)	PC45011	\$39.50
1937-1953 All Straight 8, 6 volt, negative ground (Chrome)	PC45001	\$49.50
1953-1974 All (Black)	PC40011	\$37.50
1953-1974 All (Chrome) 12 v	PC40001	\$46.50
1953-1974 All (For Ignitor II applications only - Chrome) 12 v	PC45001	\$49.50
1953-1974 All (For Ignitor II applications only - Black) 12 v	PC45011	\$39.50
Coil Bracket	CB350	\$6.50
Coil Bracket (Chrome)	CB350C	\$11.50

HIGH PERFORMANCE SPARK PLUG WIRES

Low 500 ohm/ft. resistance with spiral wound alloy to suppress electromagnetic radiation plus redundant current paths.

V-8 7.0mm Stock-Look Custom Set

1953-1960 All	PW708103	\$44.50
1960-1967 Special, Skylark, GS (Ex 1967 GS 400)	PW708103	\$44.50
1967-1966 LeSabre, Wildcat, Invicta, Electra, Riviera All 364, 401, 425 Engines	PW708105	\$44.50
1967 GS-400	PW708102	\$44.50
1968-1974 All 350, 400, 430, 455 w/o HEI	PW708102	\$44.50

6 CYLINDER 7.0mm STOCK-LOOK Custom Set

1968-1974 ALL	PW706101	\$44.50
---------------------	----------	---------

Electrical (Group 2)

Generator Rebuilding Service

- 1960-1962** All without air conditioning.
 G602.....\$189.50 ea.
1961-1962 All with air conditioning.
 G612.....\$189.50 ea.



- 1961-1962** Generator brush set.
 GBS401\$5.75 ea.

- 1961-1962** Generator front bearing.
 GEB412.....\$8.75 ea.
1963-1971 All. Alternator front bearing.
 GEB581.....\$15.75 ea.
1972-1973 All. Alternator front bearing.
 GEB723.....\$11.25 ea.



- 1983-1987** All. Alternator drive end bearing.
 GEB838.....\$16.00 ea.

Distributor Rebuilding Service

See NOS Group 2.361 Section for outright Sales

- 1961-1966** 364, 401 and 425 engines.
 D596.....\$167.50 ea.
1964-1965 300 engines.
 D647.....\$167.75 ea.
1966-1967 340 engines.
 D667.....\$167.75 ea.
1967-1968
 1967: 400 and 430 engines;
 1968-1974: All.
 D674.....\$167.75 ea.



Distributor Vacuum Advance Controls

- 1961-1974** All. Oem replacement.
 VC600.....\$16.25 ea.
1971-1974 All 350 engines and 455 stage 1.
 VC724.....\$16.25 ea.

Distributor Knock Sensor (2.383)

- 1983-1984** LeSabre and Electra w/ 4.1-4;
1984 LeSabre 231A;
1985-1988 Skylark, Somerset 3.0L.
 KS838.....\$36.00 ea.



Alternators



- 1963-1971** all 61 amp. Sold outright.
 A631.....\$69.50

Please Call us about Alternator Rebuilding

Alternator Brush Sets

- 1964-1967** all 62 amp. alternators.
 ABS647.....\$7.75 set
1962 all;
1963-1967 all except 62 amp.
 alternators;
1968 thru 1971 all.
 ABS621.....\$12.75 set



Alternator Contact Rubber Boot



- 1963-1972** Alternator contact rubber
 insulating boot.
 AB632.....\$4.50 ea.

Alternator Pulley (2.275)

- 1961-1975**
 1961-1970: All generators and alternators;
 1971-1975: All 37 amp-42 amp.;
- AP575.....TOS
1972 All with AC.
 AP72.....TOS

Alternator Fan (2.274)

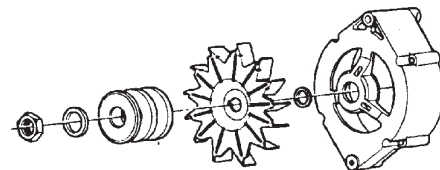

- 1961-1975**
 1961-1962: All;
 1963-1965: All except 62 AMP.;
- 1967-1975:** All except 80 AMP.(correct cadmium plating).
 AF585.....\$16.50 ea.

Headlamp Switches



1961-1963 All headlight switch.
HS593\$49.50 ea.

1964-1967 All.
HS647\$28.50 ea.
HC645.....(connector plug for above).....\$9.75 ea.

1968-1977 All except 73-75 with twilight sentinel.
HS685\$25.50 ea.
HC645.....(connector plug for above).....\$9.75 ea.

Headlight Dimmer Switch



1961-1975 All except guidematic.
HDS615\$9.00 ea.



1976-1990 Headlamp dimmer actuator. All with tilt or tele.
HDA760\$4.75 ea.



1963-1968 Headlamp body and beam adjustment nut.
HN634.....\$1.25 ea.



1964-1969 All. Headlamp bezel mounting nut.
HBN649\$2.25 ea.



1969-1972 Heading bezel retaining nut.
HBN692\$2.50 ea.
HBN692S.....(Set of 8).....\$18.50 set.



1969-1974 All except Apollo and Regal, headlamp beam adjusting nut and screw.
HN692.....\$3.75 ea.



1963-1964 Dome lamp switch rubber boot on door post.
SB634\$7.00 ea.



1961-1969 All. Sealed beam retainer screw. 6 per car.
HS400.....\$1.25 ea.



1970-1975 Headlamp assembly to core support pads. White nylon. 12 per car.
HP705.....\$2.25 ea.
HP705S.....(Set of 12).....\$20.50 set

Marker Lamps and Lamp Parts

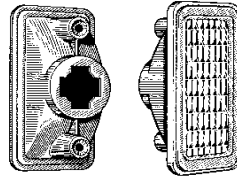

1968 Left and right front marker lamp.
MLF689\$16.50 ea.



1968-1969 Front marker lamp gasket. Small rectangular.
MLG689.....\$4.00 ea.

Horns

1961-1999 All. (replacement type) May not look the same as original. Bracket and wire as necessary.
H610L.....(Low Note).....\$59.50 ea.
H610H.....(High Note).....\$59.50 ea.



Horn Relays (2.815)



1961-1967 All with junction block.
HR617\$79.75 ea.

1965-1968 All with relay only.
HR658.....\$16.50 ea.

1968 All "Littlefuse".
HR658L.....\$39.50 ea.

Horn Blowing Contact Spring

1966-1974
1966 thru 1974 all with standard wheel.
HS666.....\$7.75 ea.



Signal Flasher



1961-1975 All.
SF615.....\$4.25 ea.



1965 All. Back-up lamp rubber bumper.
GDB635.....\$5.00 pr.

Map Lens



1963-1964 LeSabre, Wildcat, and Electra;
1963-1965 Rivera;
ML635.....\$12.75 ea.

Electrical (Group 2)

Genuine Guide T-3 Headlight Bulbs

- 1961-1967 All**
 SB607S.....\$149.00 set of four (4)
1968-1971 All.
 SB681S.....\$149.00 set of four (4)



- 1965 LeSabre, Wildcat, Electra.** Parking lamp lens gaskets.
 PLG65B.....\$12.75 pr.

Back-Up Lamp Lenses

- 1962 LeSabre and Invicta except wagons.**
 BL62L.....Left hand side.....\$16.50 ea.
 BL62R.....Right hand side.....\$16.50 ea.



- 1963 LeSabre and Wildcat .** Fits either side.
 BL63.....\$16.50 ea.

Back-Up Lamp Switch

- 1963-1965 LeSabre, Wildcat, Electra** with 4 speed manual transmission.
 BLS636\$59.50 ea.

Back-Up Light Switch

- 1967-1968 LeSabre, Wildcat, Electra** all manual transmission with floor shift..
 BLS678\$59.50 ea.

Turn Signal Switches (2.895)



- 1967-1968 All w/o tilt wheel.** Delco color code white or green. Includes wiring.
 DSS678\$45.00 ea.
1969-1972 All w/o cornering lamps. Includes wiring.
 DSS696\$46.25 ea.
 (for cars w/o cornering lamps)

Headlamp Switches

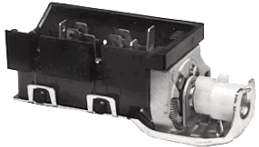
- 1961-1963 All.**
 HS593.....\$49.50 ea. 
1964-1967All.
 HS647.....\$28.50 ea.
 HC645.....(connector plug for above).....\$9.75 ea.
1968-1972 All.
 HS685\$25.50 ea.
 HC645.....(connector plug for above).....\$9.75 ea.

Tail Lamp to Body Gaskets

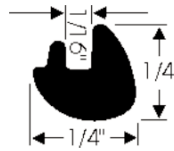

- 1965 LeSabre, Wildcat, Electra.** Correct profile rubber extrusion. Join at bottom.
 2-24" pieces.
 TLP65.....\$22.25 pr.



- 1966 All LeSabre and Wildcat** tail lamp to housing gaskets.
 TLP66.....\$27.75 pr.

Tail Lamp Lenses

- 1961 LeSabre, except wagons.** Replaces OEM #5952047, 8.
 TL61L.....LH Side.....\$49.50 pr.
 TL61R.....RH Side.....\$49.50 pr.
1961 Invicta & Electra. Replaces OEM #5951943, 4.
 TL61EL.....LH Side.....\$49.50 pr.
 TL61ER.....RH Side.....\$49.50 pr.
1963 All LeSabre, Wildcat except wagons. Replaces OEM #5953897. Fits either side.
 TL63\$26.50 pr.
1964 Electra. Replaces OEM #5955139. Fits either side.
 TL64E.....\$69.50 ea.



Tail Lamp Lens Gaskets



- 1966 All LeSabre and Wildcat** tail lamp lens gaskets.
 TLG66\$26.50 pr.

Back-Up Lamp Lens Gaskets



- 1965 All LeSabre, Wildcat, Electra.** Back-up lens gaskets.
 BLG65B.....\$9.75 pr.



- 1966 All LeSabre and Wildcat** back-up lens gaskets.
 BLG66\$14.50 pr.



- 1968 All;**
1969-1972 All exc. Electra. Back-up lens gasket.
 BLG682.....TOS



License Lamp Lens Gaskets

- 1962 and 1964 LeSabre, Wildcat, Electra.**
 LLG624.....\$4.25 ea.
1965-1968 All. License lamp lens gasket.
 LLG643.....\$6.75 ea.



Headlamp Sockets



For 3 prong beam numbers SB6, 6006, SB12, 6012, SB2, 4000 and 4002.
PT6\$4.75 ea.



For 2 prong beam numbers SB1, 4001.
PT7\$4.25 ea.

Lamp Sockets and Pigtails



Single contact with lead. Fits bulb numbers 51, 53, 55 and 57.
PT1\$2.25 ea.



Single contact with lead. Fits bulb numbers 63, 67, 81, 87, 89, 1073, 1129, 1133, 1141 and 1156.
PT2\$2.25 ea.



Double contact with lead. For ears reversed. Bulbs numbers 82, 88, 90, 210, 1004, 1034, 1154 and 1157.
PT3\$2.75 ea.



Double contact with lead. For ears aligned bulbs.
PT4\$2.50 ea.

Parking and Tail Lamp Sockets

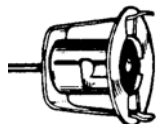

Single contact with lead. For 3/4" to 1 1/8" hole.
LS1\$5.75 ea.

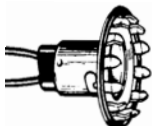

Double contact with lead. For bulb numbers 1034 and 1154. Fits 1 1/8" hole.
LS5\$5.75 ea.

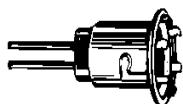

Double contact with leads. Fits 3/4" hole. For bulb numbers 1034, 1154 and 1157.
LS9\$5.75 ea.



Double contact with leads. Fits 3/4" to 1 1/8" hole. For bulb numbers 1034, 1154 and 1157.
LS2\$5.75 ea.



Double contact with leads. Fits 3/4" to 1 1/8" hole. For bulb numbers 82, 88, 90, 210 and 1004.
LS3\$7.75 ea.



Double contact with leads. Fits 1 1/8" hole. For bulb numbers 1034, 1154 and 1157.
LS4\$5.75 ea.

Interior/Dash Sockets



Single contact with lead for dome etc. For bulb numbers 63, 67, 81 89, 1073, 1129 and 1133.
PT8\$6.75 ea.



Double contact with lead. For dome and map lamps. Reversed ears. Bulb numbers 82, 88, 90, 210 and 1004.
PT9\$6.75 ea.



Double contact with lead for ears aligned bulbs.
PT10\$4.75 ea.

Back-Up and License Lamp Sockets

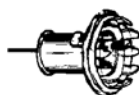

Single contact with lead. Fits 3/4" hole. Bulb numbers 63, 67, 81, 89 1129 and 1133.
LS6\$6.00 ea.



Single contact with lead. Fits 1 1/8" hole. For bulb numbers 63, 67, 81, 89, 1129 and 1133.
LS8\$6.00 ea.

Bulbs and Fuses (Group 2)



Bulbs (8.991)



Year & Model	Head-light	Parking	Direction Signal		Tail	Stop	License Plate	Instrument	Indicator	Dome	Back-up	Marker lamp	
			Front	Rear								Left	Right
1963	SB1, SB2	B1034	B1034	B1034	B1034	B1034	B67	B57161	B194	B901004	B1073	----	----
1964	SB1, SB2	B1157A	B1157	B1157	B1157	B1157	B97	B161194	B194	B901004	B1156	----	----
1965	SB1, SB2	B1157A	B1157A	B1157	B1157	B1157	B97	B161194	B194	B901004	B1156	----	----
1966	SB1, SB2	B1157A	B1157A	B1157	B1157	B1157	B97	B194	B194	B901004	B1156	----	----
1967	SB1, SB2	B1157A	B1157A	B1157	B1157	B1157	B97	B194	B161	B211	B1156	----	----
1968	SB1, SB2	B1157A	B1157A	B1157	B1157	B1157	B97	B1941893	B194	B901004	B1156-1157	B194A	B194
1969	SB1, SB2	B1157A	B1157A	B1157	B1157	B1157	B97	B1811893	B194	B901004	B1157	B194A	B194
1970	SB1, SB2	B1157A	B1157A	B1157	B1157	B1157	B97	B181194	B194	B211	B1157	B194A	B194
1971	SB1, SB2	B1157A	B1157A	B1157	B1157	B1157	B97	B161194	B194	B211	B1157	B194	B194
1972	SB1, SB2	B1157A	B1157A	B1157	B1157	B1157	B97	B161194	B194	B211	B1157	B194	B194
1973	SB1, SB2	B1157A	B1157A	B1157	B1157	B1157	B97194	B194	B194	B211	B1157	B194	B194
1974	SB1, SB2	B1157A	B1157A	B1157	B1157	B1157	B194	B168	B194	B211	B1157	B194	B194
1975	SB1, SB2	B1157A	B1157A	B1157	B1157	B1157	B194	B168	B161	B211	B1157	B194	B194
1976	SB1, SB2	B1157A	B1157A	B1157	B1157	B1157	B194	B168	B161	B211	B1157	B1157A	B1157
1977	SB1, SB2	B1157A	B1157A	B1157	B1157	B1157	B168	B161	B161	B56189	B1156	B194A	B168
1978	SB1, SB2	B1157A	B1157A	B1157	B1157	B1157	B168	B161	B161	B56189	B1156	B194A	B168

Prices: B51-\$1.50, B53-\$1.50, B55-\$1.50, B57-\$1.25, B63-\$1.25, B67-\$1.50, B81-\$1.75, B82-\$1.50, B87-\$2.00, B88-\$2.50, B89-\$2.00, B90-\$2., B210-\$5.25, B1000-\$5.75, B1004-\$2.75, B1034-\$2.75, B1073-\$2.75, B1129-\$2.75, B1133-\$4.00, B1154-\$2.00, B1157-\$2.00, B2330-\$8.75, B2331 (High Intensity Bulb)-\$16.50, SB1-\$11.25, SB2-\$11.25, SB6-\$12.50, SB12-\$12.25.

NOTICE

CAR SHOW ATTENDEES

CARS, Inc. will NOT bring the usual "yellow trailer" to the shows. We will be happy to bring any parts you need.

Please call in advance of the show to place your order.

Look For Us!

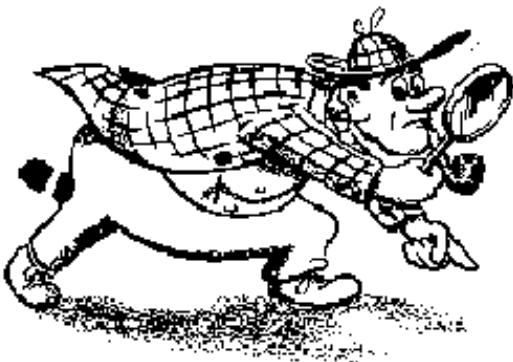

If your thinking of attending any of the shows listed below, be sure to stop by and say "Hello". We will be glad to discuss some of our newest items or simply talk about your **BUICK**.

Plan ahead by calling-in your order weeks ahead of time. We will be able to bring your entire order and save you shipping too.

*GS Nationals
Buick Nationals
Hershey

GBM-12

near Lamp Post 86