

# BUICK PARTS: GROUP NUMBERS

Engine • Clutch • Decals.....	Group 0
Cooling • Oiling • Grills .....	Group 1
Electrical • Lamps .....	Group 2
Fuel • Carburetion • Exhaust.....	Group 3
Transmission • Brakes .....	Group 4
Wheels • Propeller Shaft • Rear Axle .....	Group 5
Front Suspension • Steering .....	Group 6
Frame • Springs • Shocks • Bumpers .....	Group 7
Hood • Front Fenders • Running Boards.....	Group 8
Heater • Air Conditioner • Firewall • Radio • Antenna .....	Group 9
Glass • Doors • Cowl • Weatherstrip • Wiper • Dash.....	Group 10
Rear 1/4 Glass • Seats • Door Sills • Dome Lenses .....	Group 11
Rocker Panels • Rear Sheet Metal • Deck Lid.....	Group 12
Convertible Tops and Parts .....	Group 13
Door Panels • Misc. Interior • Headlinings .....	Group 14
Carpet • Floor Mats • Trunk Linings .....	Group 15
Literature.....	Group 16

## **-ATTENTION-**

This catalog pertains to  
**1961 and Up Special, Skylark,  
Sportwagon and Gran Sport ONLY**

**We also have catalogues and stock Buick parts for:**

- **1930's and Up** All models
- **1961 and Up** Riviera
- **1961 and Up** Lesabre, Invicta, Wildcat, Electra 225, Centurion, Century and Apollo
- **1973 and Up** Regal, Grand National, T-Type and GNX

*Please inquire about separate catalogs for the above Buicks*

**[www.oldbuickparts.com](http://www.oldbuickparts.com)**

All rights reserved. No part of this publication may be reproduced without prior written permission from CARS, Inc. Illustrations in this catalog are representations only and may not exactly depict any particular part or part number. Prices subject to change without notice.

# Typical Buick Engine

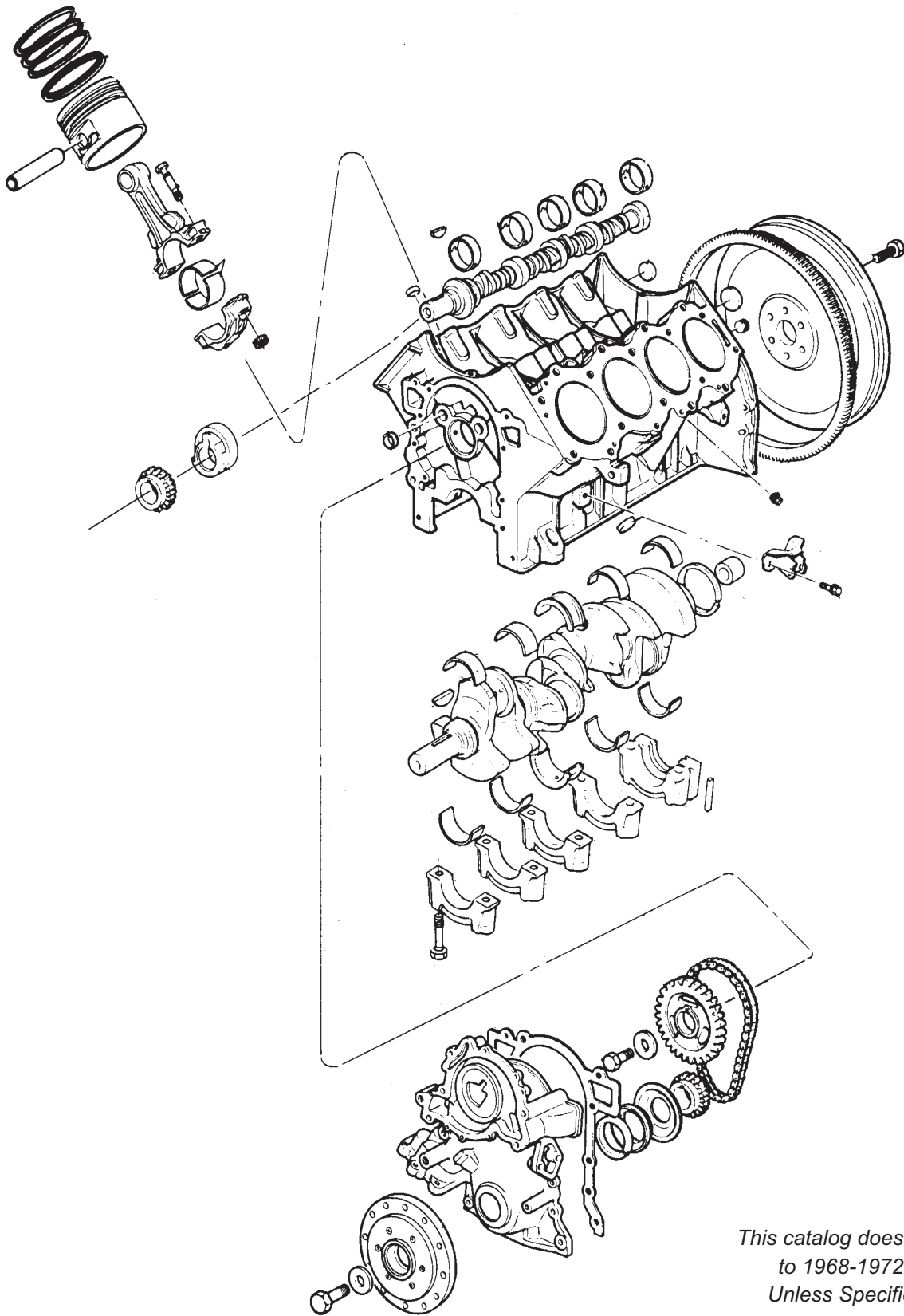

*This catalog does not pertain  
to 1968-1972 L6 motors.  
Unless Specifically noted.*



## Motor Mounts (.027)



**1961-1963** 198 and 215 engines.

MM613.....\$65.00 pr.

**1965-1967** 300 and 340 engines.

MM657.....\$24.00 pr.

**1967-1976** 400 and 455 engines. All with four hole flange.

MM676.....\$52.75 pr.

**1968-1972** 250 engine.

MM682.....\$52.75 pr.

**1968-1980** 350 engine.

MM685.....New Lower Price.....\$42.25 pr.

## Motor Mount Rebuilding Services

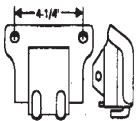

**1964** All 225 V-6 and 300 V-8. There are two types. This is not the interlocking type.

MM64.....\$204.00 pr.

**1965-1966** 400 engine.

MM656RS.....\$160.50 pr.

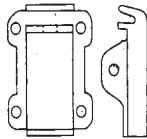

**1965-1967** V-6 w/o a.c.

MM657V6.....\$183.50 pr.

**1965-1967** V-6 with a.c.

MM657V6A.....\$183.50 pr.

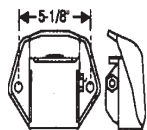

**1967 GS** There are two types. This is not the interlocking type.

MM670.....\$192.00 pr.

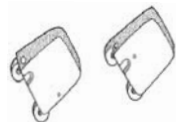

## Big Block Conversion

**1968-1972 All.** Motor Mount frame pads for conversion from 350 to 400 or 455 engines.

FP455.....\$90.25 pr.

## Main Bearing Sets

**1961-1963** 215 engine.

MBS613.....\$129.50 ea.

**1962-1963** 198 engine.

MBS623.....\$101.00 ea.

**1964-1967** 300 engine.

MBS647.....\$104.00 ea.

**1964-1967** 225 engine.

MBS647S.....\$60.00 ea.

**1965-1966** 400 engine.

MBS596.....\$129.75 ea.

**1966-1980** 340 and 350 engine.

MBS666.....\$84.00 ea.

**1967-1969** 400 engine.

MBS679.....\$97.50 ea.

**1968-1972** 250 engine.

MBS685.....\$61.00 ea.

**1970-1976** 455 engine.

MBS706.....\$99.50 ea.

## Valves

**1964** 225 and 300 engines (EXHAUST).

EV64.....\$18.25 ea.

**1964** 225 and 300 engines (INTAKE).

IV64.....\$18.25 ea.

**1965-1966** 400,401 engine ( INTAKE ).

IV596.....\$14.25 ea.

**1965-1966** 400, 401 engine ( EXHAUST ).

EV596.....\$16.50 ea.

**1965-1967** 225, 300 & 340 engines ( EXHAUST ).

EV657.....\$18.25 ea.

**1967-1976** 400 and 455\* eng. ( INTAKE ). Except GS STAGE I.

IV676.....\$11.50 ea.

**1967-1972** 400, 455\* eng ( EXHAUST ). \* Except GS STAGE I.

EV674.....\$14.75 ea.

**1968-1972** 250 engine ( INTAKE ).

IV686.....\$14.25 ea.

**1968-1970** 250 engine ( EXHAUST ).

EV680.....\$15.50 ea.

**1968-1980** 350 engine ( EXHAUST ).

EV683.....\$18.25 ea.

**1971-1972** 250 engine ( EXHAUST ).

EV716.....\$15.50 ea.

**1968-1980** 350 engine ( INTAKE ).

IV680.....\$10.00 ea.

**1971-1972** 455 STAGE 1 ( INTAKE ).

IV714.....\$17.00 ea.

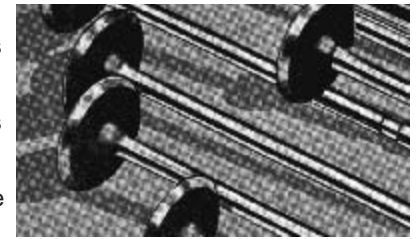

## Valve Guides

**1961-1963** 215 engine ( INTAKE ).

VG880.....\$3.00 ea.

**1961-1963** 215 engine ( EXHAUST ).

VG880.....\$3.00 ea.

**1962-1963** 198 engine ( INTAKE ).

VG7259.....\$3.00 ea.

**1962-1963** 198 engine ( EXHAUST ).

VG7259.....\$3.00 ea.

**1964-1967** 225 engine ( INTAKE ).

VG6105.....\$3.00 ea.

**1964** 225 engine ( EXHAUST ).

VG6105.....\$3.00 ea.

**1965** 400 engine ( INTAKE ).

VG733.....\$4.00 ea.

**1965** 400 engine ( EXHAUST ).

VG733.....\$4.00 ea.

**1965-1967** 225 engine ( EXHAUST ).

VG7460.....\$2.25 ea.

**1965-1967** 300 and 400 engines( INTAKE ).

VG5607.....\$3.00 ea.

**1965-1967** 300 and 340 engines ( EXHAUST ).

VG7460.....\$2.25 ea.

**1966** 400 engine ( INTAKE ).

VG937.....\$3.00 ea.

**1967-1972** 400 and 455 engines ( INTAKE ).

VG6113.....\$2.75 ea.

**1967-1972** 400 and 455 engines ( EXHAUST ).

VG6114.....\$2.75 ea.

**1968-1972** 250 engine ( INTAKE ).

VG6867.....\$3.00 ea.

**1968-1972** 250engine ( EXHAUST ).

VG5607.....\$3.00 ea.

**1968-1972** 350 engine ( INTAKE ).

VG6108.....\$3.00 ea.

**1968-1972** 250 engine ( EXHAUST ).

VG6113.....\$2.75 ea.



# Engine Parts (Group 0)

## Valve Springs and Sets

<b>1961-1964</b> 198, 215, 225 and 300 engine.	
VS614.....	\$5.00 ea.
Set: Sixteen ( 16 ) same as above.	
VS614S.....	\$58.00 set
<b>1965-1966</b> 400 engine ( INNER ).	
VS536.....	\$5.00 ea.
Set: Sixteen ( 16 ) same as above.	
VS536S.....	\$58.00 set
<b>1965-1966</b> 400 engine ( OUTER ).	
VS596.....	\$4.75 ea.
Set: Sixteen ( 16 ) same as above.	
VS596S.....	\$52.25 set
<b>1965-1967</b> 225, 300 and 340.	
VS657.....	\$5.00 ea.
Set: Sixteen ( 16 ) same as above.	
VS657S.....	\$58.00 set
<b>1967-1972</b> .....400,455 ( Exc. Hvy Duty, & GS STAGE I).	
VS672.....	\$4.50 ea.
Set: Sixteen ( 16 ) same as above.	
VS672S.....	\$53.25 set
<b>1968-1974</b>	
<b>1968-1970</b> 350 engine Int. and Exh.;	
<b>1971</b> 350 Int.;	
<b>1972-1974</b> Int. and Exh.	
VS684.....	\$3.25 ea.
Set: Sixteen ( 16 ) same as above.	
VS684S.....	\$44.00 set
<b>1971</b> 350 with Damper ( Exhaust ).	
VS71D.....	\$5.00 ea.

## Valve Spring Retainers (.310)

<b>1965-1966</b> All 400, 401, 425 engines;	
<b>1967-1975</b> All V-8 engines. 32 pairs needed per car.	
VR365.....	\$3.00 pr.
VR365S.....	(Set of 32).....\$42.50 set

## Valve Lifters (Hydraulic)

<b>1961-1967</b>	
<b>1961-1966:</b> All;	
<b>1967:</b> 300 and 340 engines.	
VL567.....	\$9.50 ea.
VL567S.....	(Set of 16).....\$139.50 set
<b>1967-1969</b>	
<b>1967-1969</b> 400,430 engine;	
<b>1968-1969</b> 350 engine (with hollow push rods).	
VL679.....	\$7.00 ea.
VL679S.....	(Set of 16).....\$102.50 set
<b>1970-1981</b> All 350 and 455 engines.	
VL680.....	\$4.75 ea.
VL680S.....	(Set of 16).....\$69.50 set



## Valve Seat Inserts and Sets

( Sold in sets of 12 or 16 as needed for your Buick )

<b>1962-1963</b> 198 engine ( intake ).	
VSI590.....	\$4.75 ea.
<b>1962-1963</b> 198 engine ( exhaust ).	
VSI623.....	\$3.75 ea.
<b>1961-1963</b> 215 engine ( exhaust ).	
VSI614.....	\$4.00 ea.
<b>1961-1963</b> 215 engine ( intake ).	
VSI590.....	\$4.75 ea.
<b>1964-1967</b> 225, 300 engine ( intake ).	
VSI648.....	\$8.00 ea.
<b>1968-1972</b> 250 engine ( intake ).	
VSI682.....	\$4.75 ea.
<b>1965-1967</b> 225 engine ( exhaust ).	
VSI557.....	\$4.50 ea.
<b>1964</b> 225 & 300 engine ( exhaust ).	
VSI614.....	\$4.00 ea.
<b>1968-1972</b> 250 engine ( exhaust ).	
VSI572.....	\$4.50 ea.
<b>1965-1966</b> 400 engine ( intake ).	
VSI592.....	\$4.75 ea.
<b>1965-1966</b> 400 engine ( exhaust ).	
VSI590.....	\$4.75 ea.
<b>1965-1967</b> 300 and 340 engine ( intake ).	
VSI657.....	\$5.75 ea.
<b>1965-1967</b> 300 and 340 engine ( exhaust ).	
VSI557.....	\$4.50 ea.
<b>1967-1969</b> 400 engine ( intake ).	
VSI674N.....	\$6.75 ea.
<b>1970-1972</b> 455 engine ( intake ).	
VSI674.....	\$8.00 ea.
<b>1967-1969</b> 400 engine ( exhaust ).	
VSI648E.....	\$4.25 ea.
<b>1970-1972</b> 455 engine ( exhaust ).	
VSI704.....	\$5.00 ea.
<b>1968-1972</b> 350 engine ( intake ).	
VSI592.....	\$4.75 ea.
<b>1968-1972</b> 350 engine ( exhaust ).	
VSI590.....	\$4.75 ea.

## Valve (Stem) Seals

<b>1961-1972</b>	
<b>1961-1963</b> 198 and 215 engine;	
<b>1964-1967</b> 225 and 300 engine;	
<b>1966-1967</b> 340 engine;	
<b>1968-1972</b> 250 engine.	
VSS612.....	\$2.75 ea.
<b>1967-1972</b>	
<b>1967-1969</b> 400 engine;	
<b>1968-1972</b> 350 engine;	
<b>1970-1972</b> 455 engine.	
VSS674.....	\$2.75 ea.
<b>1965-1966</b> 400 engine.	
VSS536.....	\$3.00 ea.

## Valve Cover / Intake Manifold Ventilation Grommets

<b>1963-1974</b>	
<b>1963-1967:</b> Valve Cover, All;	
<b>1967-1974:</b> Intake Manifold, All.	
VG634.....	\$7.75 ea.
<b>1970-1974</b> Valve Cover ( Rubber ).	
VG704.....	\$4.25 ea.



### Rocker Arm Shafts

- 1961-1967 215, 300 and 340 engines.  
RS617 .....\$65.00 ea.
- 1962-1967 All V-6.  
RS627 .....\$55.00 ea.
- 1965-1966 400 engines.  
RS536 .....\$48.50 ea.  
RS536P.....Pair.....\$89.50 pr.
- 1967 400 engine.  
RS67 .....\$55.00 ea.
- 1968-1969 350 engine.  
RS689S.....\$44.75 ea.
- 1968-1969 400, 430 engine.  
RS689 .....\$55.00 ea.
- 1970-1972 350 engine.  
RS700 .....\$39.50 ea.
- 1970-1972 455 engine.  
RS705 .....\$55.50 ea.



### Rocker Arms



- 1961-1966 All 364, 400, 401, 425 engines.  
Fits LH 4 Rear and RH 4 Front. Reproduced in steel.  
RA596A.....\$16.00 ea.
- 1961-1966 All 364, 400, 401, 425 engines.  
Fits RH 4 Rear and LH 4 Front. Reproduced in steel.  
RA596B.....\$16.00 ea.
- 1961-1967 198, 215, 225, 300 and 340 engines,  
intake 2, 7, exhaust 1,3, 4, 5, 6, 8  
RA617A.....\$16.00 ea.
- 1961-1967 Intake 1, 3, 4, 5, 6, 8 exhaust 2, 7  
RA617B.....\$16.00 ea.
- 1968-1969 350, 400 intake 1, 4, 5, 8, exhaust 2, 3, 6, 7.  
RA689A.....\$17.00 ea.
- 1968-1969 350, 400 intake 2, 3, 6, 7, exhaust 1, 4, 5, 8.  
RA689B.....\$17.00 ea.
- 1968-1969 Complete Set of 16.  
RA689S.....\$259.00 ea.
- 1970-1972 V-8 intake 1, 4, 5, 8 exhaust 2, 3,6 ,7.  
RA705A.....\$8.50 ea.
- 1970-1972 V-8 intake 2, 3, 6, 7 exhaust 1, 4, 5, 8.  
RA705B.....\$8.50 ea.
- 1970-1972 Complete set of 16.  
RA705S.....\$105.25 ea.

### Rocker Arm Assembly

- 1962-1967 198, 225 engines.  
RAA627 .....\$95.50 ea.
- 1970-1972 455 engine.  
RAA702 .....\$180.00 pr.

### Rocker Assembly Rebuilding

- 1961-1967 All 215, 300, and 340 engines.  
RAA617 .....\$204.75 pr.
- 1961-1966 All 364, 400, 401, and 425 engines.  
RAA596 .....\$296.50 pr.
- 1967-1972 All 400, 430, 455 engines.  
RAA676 .....\$262.25 pr.
- 1968-1972 All 350 engines.  
RAA680 .....\$265.00 pr.

### Rocker Arm Retainers

- 1970-1972 All. Rocker arm retainers. For use with aluminum rocker arms. 16 per car. Nylon.  
RR702.....\$1.75 ea.

### Rocker Cover Plug

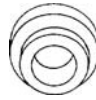

- 1964-1967 Solid plug.  
CP647.....\$11.75 ea.

### Aluminum Valve Covers



- 1963-1966 All 400,401,425 engines. Grooved with "BUICK" as original. Nice reproduction! Matte finish.  
AVC536 .....\$199.00 pr.
- 1963-1966 All 400,401,425 engines. Grooved with "BUICK" as original. Nice reproduction! Bright finish. Includes oil cap, PCV grommet, bolts and gaskets  
AVC536B.....\$199.00 pr.
- 1963-1966 All with aluminum valve covers. Chrome plated.  
WRS636.....\$34.00 pr.

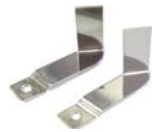

Powder coated so not to flake, peel or chip. Tall valve covers allow use of adjustable roller rockers, large valves, springs and retainers. Thick aluminum construction allows for even gasket compression and proper sealing. Will not bend, dent or distort. Results in reduced engine noise and heat.



- AVC350.....(350 Engines).....\$179.50 pr.
- AVC455....(1967-1976 400, 430, 455 Engines).....\$179.50 pr.



- 1967-1975 Valve cover retaining nut and plate.  
RCS686.....\$3.75 ea.



- 1967-1975 Valve cover retaining nut and plate. Chrome plated.  
RCS686C .....\$5.50 ea.



- 1967-1975 Valve cover retainer with tall stud.  
RCS686T .....\$5.50 ea.



- 1967-1975 Valve cover retainer with tall stud. Chrome plated.  
RCS686TC .....\$5.75 ea.

### Wire Retainer



- 1961-1966: All;  
1966: 300, 340, 400 engine ign. wire retainer on rocker covers. Two per car.  
WR596.....\$4.00 ea.



- 1967-1972 All. Front "4", ign. wire retainer. Two per car.  
WR683.....\$4.00 ea.



- 1967-1972 All. Rear "3" ign. wire retainer.  
WR673.....\$4.00 ea.

# Engine Parts (Group 0)

## Push Rods (.426)

**1962-1963** All 198 V-6 engines.

PR573.....\$7.50 ea.  
PR613S6.....(Set of 12).....\$73.50 set

**1961-1963** 215 engines.

PR613.....\$5.75 ea.  
PR613S8.....(Set of 16).....\$78.00 set

**1964** 225 and 300 engines.

PR64.....\$3.75 ea.  
PR64S6.....(Set of 12).....\$40.25 set  
PR64S8.....(Set of 16).....\$52.00 set

**1965-1967**

**1965-1967:** 225 and 300 engines;  
**1965-1966:** 400, 401, 425 engines.

PR597.....\$5.75 ea.  
PR597S.....(Set of 16).....\$78.00 set  
PR657S.....(Set of 12).....\$59.50 set

**1966-1969**

**1966-1967:** 340 engine;  
**1967-1969:** 400, 430 engines except 1969 Stage 1.

PR669.....\$3.75 ea.  
PR669S.....(Set of 16).....\$58.00 set

**1968-1969** 350 engine.

PR689.....\$4.25 ea.  
PR689S.....(Set of 16).....\$58.00 set

**1970-1981** 350 engine.

PR701.....\$4.25 ea.  
PR701S.....(Set of 16).....\$58.00 set

**1970-1976** 455 engine.

PR706.....\$4.25 ea.  
PR706S.....(Set of 16).....\$58.00 set

## Oil Slinger

**1961-1972** All.

OS615.....\$11.50 ea.

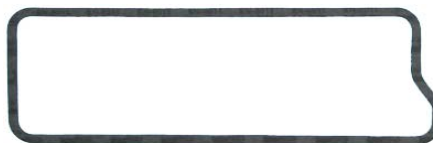

## Push Rod Cover Gaskets (.443)

**1965-1966** 400, 401 engines.

PRG576.....\$9.75 ea.

## Freeze Plug Kits

Kits contain necessary plugs for block, cam, oil holes. "B" kits contain brass water jacket plugs.

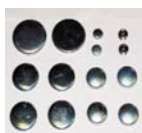

**1961-1963** All 196 engines. Steel.

FPK618.....\$8.75 ea.

**1961-1963** All 196 engines. Brass.

FPK618B.....\$9.75 ea.

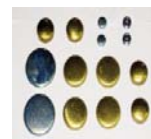

**1964-1980** All 225, 300, 340 and 350 engines. Steel.

FPK640.....\$10.50 ea.



**1964-1980** All 225, 300, 340 and 350 engines. Brass

FPK640B.....\$11.50 ea.

**1965-1966** All 400, 401, 425 engines. Steel.

FPK536.....\$18.50 ea.



**1967-1976** All 400, 430 and 455 engines. Steel.

FPK670.....\$10.00 ea.



**1967-1976** All 400, 430 and 455 engines. Brass.

FPK670B.....\$15.50 ea.



### Camshafts

<b>1961-1963</b> 215 engine.	
CS613 .....	\$129.00 ea.
<b>1964-1967</b> 300 and 340 engines.	
CS649 .....	\$154.00 ea.
<b>1965-1966</b> 400 engine.	
CS576 .....	\$154.50 ea.
<b>1967-1972</b> *400 and 455 engine.	
*Except GS STAGE I and STAGE II.	
CS676 .....	\$167.25 ea.
<b>1968-1972</b> 250 engine.	
CS686 .....	\$118.75 ea.
<b>1968-1972</b> 350 engine.	
CS680 .....	\$132.00 ea.
<b>All Years.</b> All engines. Cam break-in lube.	
CL300.....	\$6.75 ea.

### Cam Bearing Sets

<b>1962-1967</b> 198 and 225 engine.	
CBS627 .....	\$33.00 ea.
<b>1965-1966</b> 340 and 400 engine.	
CBS576 .....	\$38.50 ea.
<b>1968-1972</b> 250 engine.	
CBS685 .....	\$36.75 ea.
<b>1961-1966</b> 215, 300; <b>1967</b> 340 engine.	
CBS617 .....	\$49.00 ea.
<b>1967</b> 400; <b>1968-1972</b> All V-8.	
CBS676 .....	\$54.00 ea.

### Connecting Rods

(includes bolts):



<b>1964-1967</b> 225 and 300 engines.	
CR596 .....	\$55.00 ea.
<b>1965-1966</b> 400 engines.	
CR596 .....	\$43.25 ea.
<b>1966-1972</b> 340 and 350 engines.	
CR662 .....	\$43.50 ea.
<b>1967-1972</b> 400 and 455 engines.	
CR672 .....	\$32.00 ea.
<b>1968-1972</b> 250 engine.	
CR682 .....	\$39.00 ea.

### Rod Bearings

**1961-1972** 198, 215, 225, 300, 340 and 350 engines.  
CRB612.....\$9.00 ea.

**1965-1972** 400 and 455 engines.  
RBS576 .....

**1968-1972** 250 engine.  
CRB682.....\$6.50 ea.

### Pistons ( pins included )

**1963-1966** All 400, 401 engines. Piston and pin.  
P401S.....(Set of 8).....\$287.00 set

**1963-1966** All 425 engines. Piston and pin.  
P425 .....

**1964-1967** 225 and 300 engines.  
P647 .....

**1970-1976** All 455 engines. Piston and pin.  
P706 .....



www.oldbuickparts.com  
**908-369-3666**

7

# Engine Parts (Group 0)

## Piston Ring Sets

Our piston ring are available in standard and custom sizes such as .030, .040, .060 oversize. Add "030" etc. to part number.

**1961-1963** 198 V-6 Engine.  
 PRS613.....\$161.00 ea.

**1961-1963** 215 V-8 Engine.  
 PRS215C Standard, 30, 40 .....\$70.25 ea.  
 PRS215M Street/Strip Premium Moly. Std., 30 .....\$70.25 ea.

**1964-1967** 225 engine.  
 PRS225C Cast Iron. Standard,20,30,40,60.....\$49.00 ea.  
 PRS225M Street/Strip Premium Moly. Std.,20,30,40,60..\$70.25 ea.

**1964-1967** 300, 340 engine.  
 PRS647C Cast Iron. Standard, 30, 40, 60.....\$49.00 ea.  
 PRS647M Street/Strip Premium Moly. Std., 20,30,40,60 ..\$73.25 ea.

**1965-1966** 400, 401 engine.  
 PRS401M.....(Moly).....\$195.00 set

**1967-1969** 400 engine.  
 PRS400C Cast Iron. Standard,30,40.....\$54.50 ea.  
 PRS400M Street/Strip Premium Moly. Std., 30,40,60 ..\$69.75 ea.

**1968-1981** 350 engine.  
 PRS350M..... (Moly).....\$64.50 ea.

**1970-1976** 455 engine.  
 PRS455C Cast Iron. Standard, 30 .....\$64.50 ea.  
 PRS455M Street/Strip Premium Moly. Std,30,40,60 ...\$95.00 ea.

## Flywheels (.666)

For automatic and standard. transmission  
 (includes Ring Gear).

**1961-1963** .....Please inquire

**1964-1980** 300, 340 and 350 engines with auto. trans.  
 FW645.....\$39.50 ea.

**1964-1966** All. 400, 401 and 425 engines with auto transmission.  
 FW646.....\$133.75 ea.

**1967-1972** All. 400, 455 engines with auto transmission.  
 FW676.....\$99.00 ea.

**1967-1972** All. 400, 455 engines with std. transmission.  
 FW676S .....\$289.50 ea.



## Harmonic Balancers



**1967-1976** all 400, 430, 455 engines.  
 Sold outright.  
 HB676.....\$269.50 ea.

## Harmonic Balancer Rebuilding Service (.659)

Balancers are completely disassembled shot peened and inspected. Threaded holes are repaired and new seal saver is installed. (non-rope seal apps.). New silicone rubber is injected, then vulcanized for proper bonding. Please remove any bolted pulleys before sending. For those not listed, please inquire.



**1961-1963** All 215 V-8 engines. Riveted type.  
 HB215RS.....\$154.00 ea.

**1961-1966** All 400, 401 engines. Riveted type.  
 HB401RS.....\$199.50 ea.

**1963-1966** All 425 engines. Riveted hub seal dia. 2.00 inches, 1.440 id.  
 HB425RS.....\$199.50 ea.

**1964-1967** All 225 V-6 engines.  
 HB225RS.....\$88.25 ea.

**1964-1981** All 300, 340, 350 engines. .750 wide ring externally balanced hub and ring.  
 HB350RS.....\$88.25 ea.

**1967-1976** 400, 430, 455 engine. 1.100 wide ring. Externally balanced.  
 HB455RS.....\$199.50 ea.

## Harmonic Balancer Bolt

**1967-1972** All 400, 430, 455 engines.  
 HBB676.....\$7.50 ea.





### Timing Chain Covers

**1965-1966** All 400, 401 and 425 engines.  
TC576.....\$299.00 ea.

**1967-1976** All 400, 430 and 455 engines. Includes front seal.  
TC676.....\$479.00 ea.



### Timing Cover Seals



Our modern steel housed, silicon seals replace the OEM "rope" seal and steel retainer. A spring insert keeps pressure against balancer for improved sealing.

**1961-1966** All 400, 401, 425 engines.  
TCS536L.....\$11.75 ea.  
**1961-1967** All 215, 300, 340 engines.  
TCS617.....\$11.75 ea.  
**1964-1972** All 350 engines.  
TCS640.....\$11.75 ea.  
**1967-1972** All 400, 430, and 455 engines.  
TCS650.....\$17.00 ea.

### Valve Cover Gaskets

**1961-1967** 215, 300 and 340 engines.  
VCG617.....\$15.00 pr.  
**1962-1967** 198 and 225 V-6 engines.  
VCG627.....\$12.50 pr.  
**1967-1972** 400 and 455 engines.  
VCG676.....\$17.75 pr.  
**1968-1972** 350 engines.  
VCG686.....\$11.25 pr.

### Rear Main Seals

Replaces OEM "rope" seal.

**1964-1972** All 225, 300, 340, and 350 engines.  
RMS640.....\$18.00 ea.  
**1965-1972** All 400, 430 and 455 engines.  
RMS650.....\$25.25 ea.



### Engine Gaskets

(Group 0)

### Timing Sets With Iron Cam Gear



**1961-1972** 198, 215, 225, 300, 340 and 350 engine.  
TS610.....\$23.00 ea.  
**1965-1966** 400, 401 engine.  
TS576.....\$108.50 ea.  
TC536.....Chain Only.....\$35.50 ea.  
**1967** 400 engine early.  
TS67E.....\$68.75 ea.  
**1967-1972**  
1967 400 late;  
1968-1972 400 and 455 engine.  
TS676.....\$56.25 ea.

### Timing Cover Gasket Sets

(Sets Contain new rubber lip seal)

**1961-1963** Special and Skylark.  
TCS613.....\$27.25 set  
**1965-1966** All 400 engines  
TCS536.....\$19.50 set  
**1964-1976** All 300, 340, 350 engines  
TCS646.....\$25.25 set  
**1967-1972** 400 and 455 engines.  
TCS676.....\$25.25 set

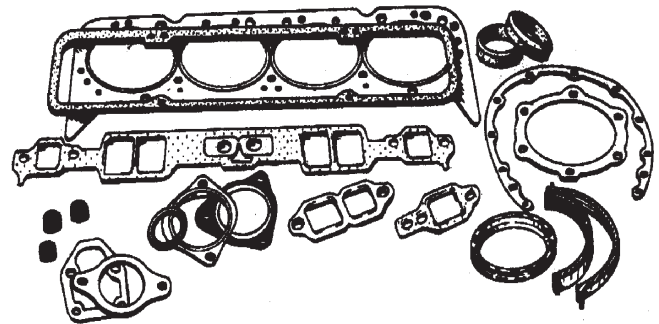

YEAR	APPLICATION	FULL ENGINE OVERHAUL SET	CYLINDER HEAD OVERHAUL SET	CYLINDER HEAD GASKETS
<b>1961-1963</b>	215 V-8 engine.....	FGS613.....\$107.50	HGS613....\$60.00	HG613....\$59.50 pr.
<b>1962-1963</b>	198 V-6 engine.....	FGS623.....\$165.75	HGS623....\$55.00	HG623....\$40.75 pr.
<b>1964-1967</b>	225 V-6 engine.....	FGS647A...\$177.25	HGS647A..\$44.75	HG647A..\$20.75 pr.
<b>1964-1967</b>	300, 340 engine.....	FGS647B....\$92.25	HGS647B..\$69.75	HG647B..\$58.00 pr.
<b>1965-1966</b>	400 engine.....	FGS576....\$129.50	HGS576....\$74.50	HG576....\$67.50 pr.
<b>1967-1972</b>	400, 455 engine *.....	FGS676.....\$81.25	HGS676....\$51.00	HG676....\$40.75 pr.
<b>1968-1972</b>	350 engine *.....	FGS686.....\$84.25	HGS686....\$41.50	HG686....\$36.75 pr.

\* Intake manifold gasket not included. To order, please see Group 3.

# Clutch Parts (Group 0)

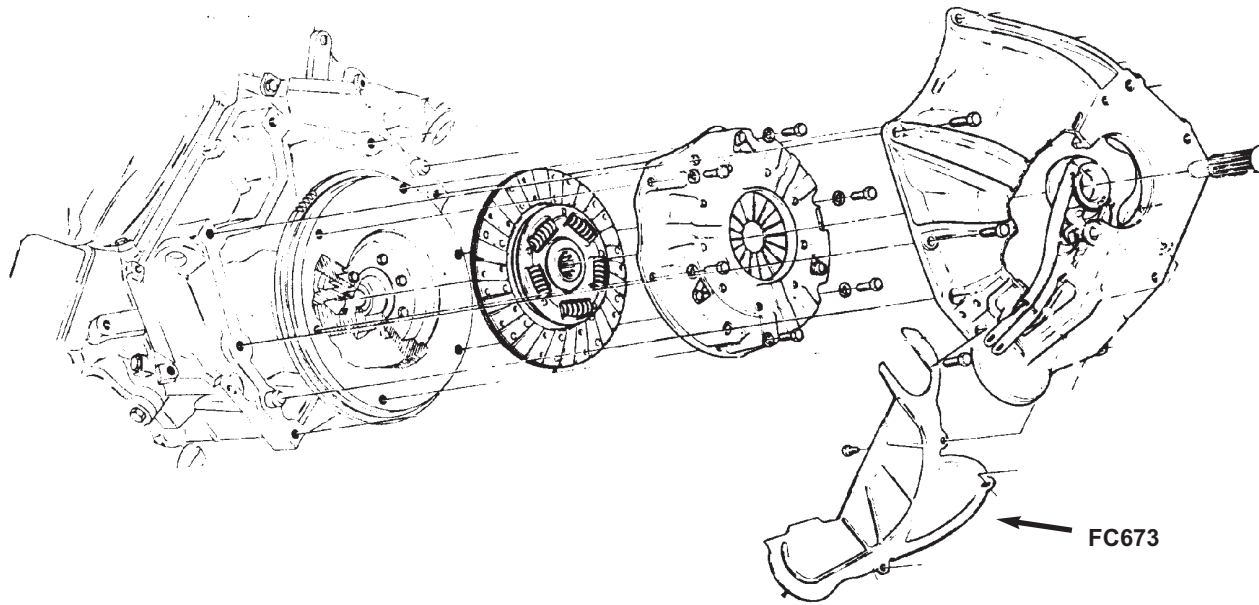

## Pressure Plate Assemblies

New - GM

1964-1972 300, 340 and 350 engines.

PP643.....\$202.00 ea.

1967-1972 400 and 455 engines.

PP673.....\$202.00 ea.



## Lower Flywheel Cover

1967-1972 300, 340, 350 and 455 engines with standard shift.

FC673.....\$69.75 ea.

## Pilot Bearing

1961-1972 All.

PB570.....\$8.25 ea.

## Clutch Discs



1961-1972

*Please inquire about our Rebuilding Service.*

## Clutch Release Bearings

1968-1972 350 engines.

TB685.....\$44.75 ea.

1961-1972

1961-1963: All;

1967-1972: 400 and 455 engines.

TB615.....\$51.25 ea.

1964-1967 225, 300 and 340 engines.

TB647.....\$44.75 ea.

## Clutch Fork

1966-1972 340 and 350 engines.

CF662.....\$59.00 ea.

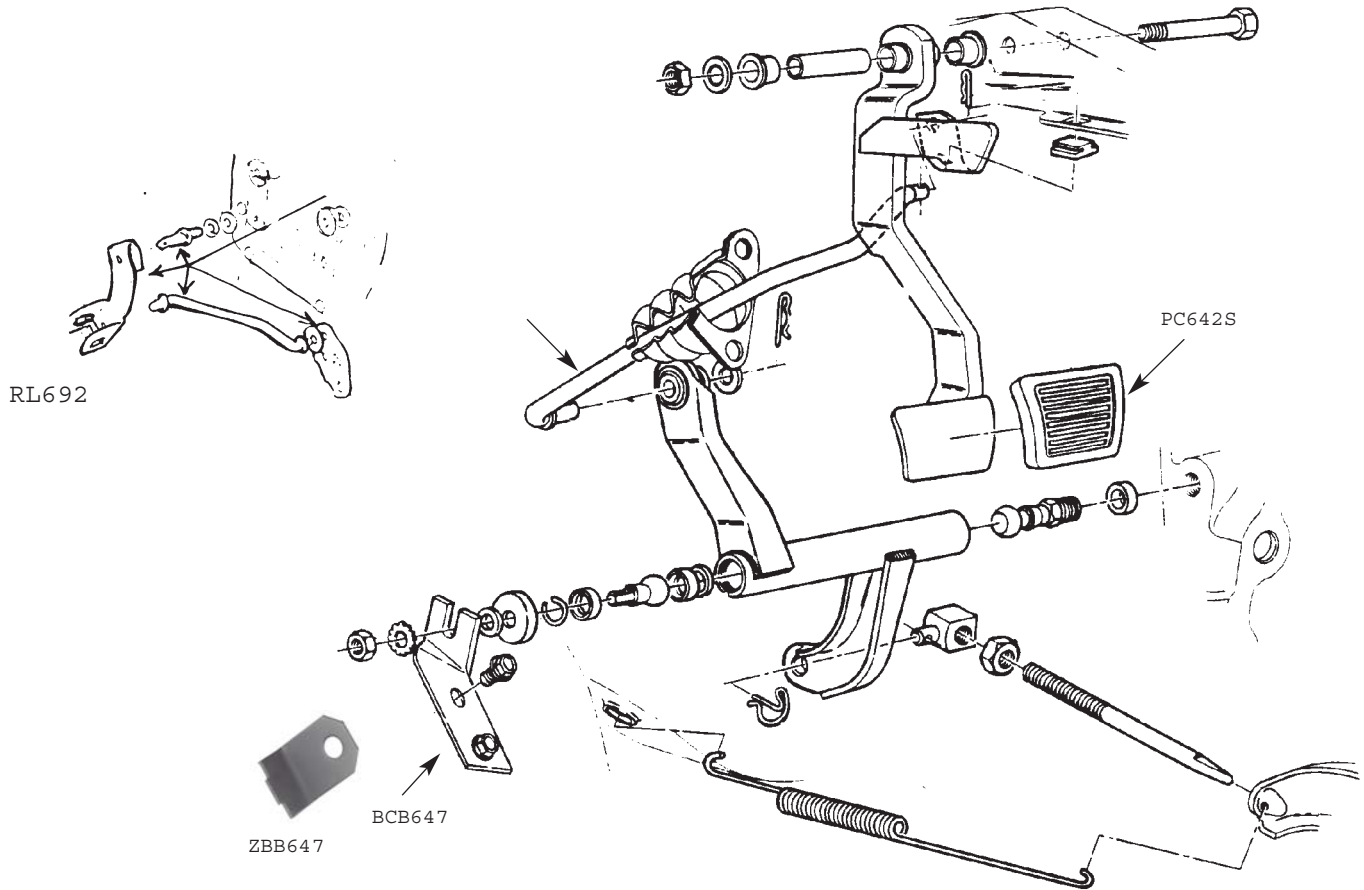

### Clutch Adjusting Rods

<b>1964-1966 All. Upper Clutch Rod. 14 1/8"</b>	
CR646 .....	\$29.75 ea.
<b>1967 All. Upper Clutch Rod. 14 3/8"</b>	
CR67 .....	\$28.50 ea.
<b>1968-1972 All 400, 455 engines. Upper clutch rod. 14 7/8".</b>	
CR685 .....	\$29.75 ea.

### Clutch Pedal

<b>1964-1972 All. ( Same Brake Pedal ).</b>	
PC642S .....	\$10.75 ea.

### Bell Crank Support Bracket

<b>1964-1967 All. Weld on.</b>	
BCB647 .....	\$14.25 ea.
<b>1968-1972 All. Bolt on.</b>	
BCB682 .....	\$16.50 ea.
<b>1964-1967 Z-Bar return spring bracket.</b>	
ZBB647 .....	\$19.00 ea.

### Clutch Boots

<b>1964-1972 Clutch fork to bell housing.</b>	
CB642 .....	\$9.00 ea.
<b>1964-1967 Clutch rod to firewall.</b>	
CB647 .....	\$12.75 ea.
<b>1968-1972 Clutch rod to firewall.</b>	
CB682 .....	\$15.00 ea.

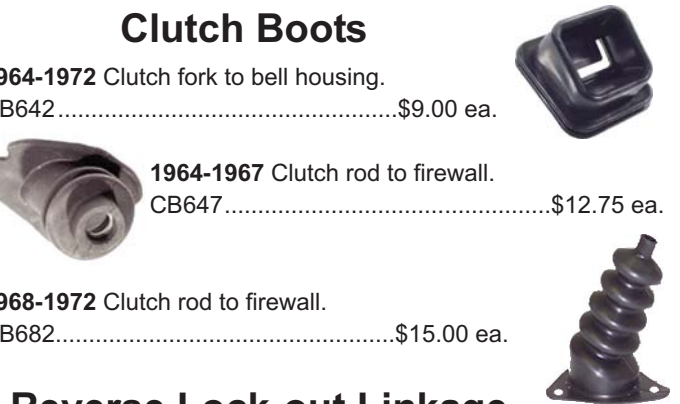

### Reverse Lock-out Linkage

<b>1969 -1972 All w/ 4-speed Muncie.</b>	
RL692 .....	\$81.75



BCB647

BCB682

ZBB647

# Buick Engine Enamel (Group 0)

**Exact Original Colors to Authenticate your Engine. Our Enamels are the Finest available. Very High Temperature. Can be easily Brushed or Sprayed to obtain a Rich Deep Gloss. Sold in Quart or Spray Cans.**

**\* Note: Spray cans can not be shipped by Air.**

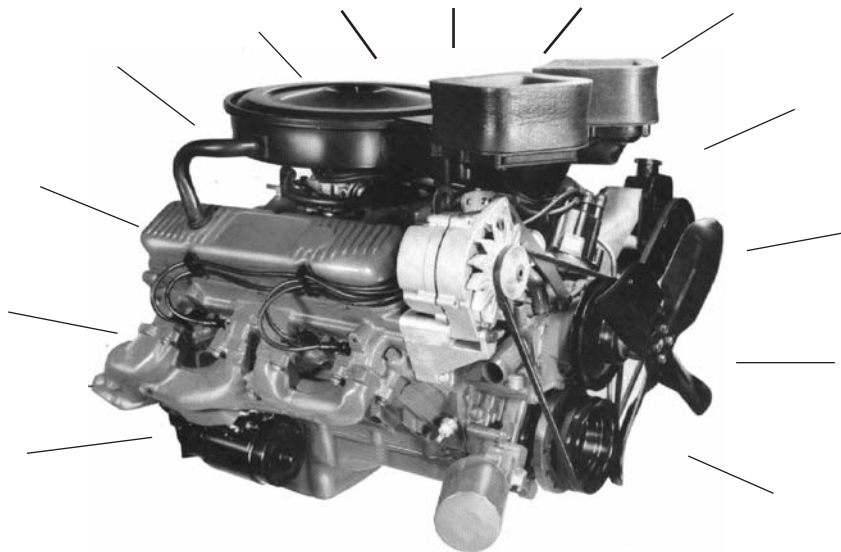

## High Heat - High Gloss



Quart Cans



12 oz. Spray Can

<b>1961-1964</b>	Buick Silver	EP614 .....	\$27.50 ea.	EP614S.....	\$14.00 ea.
<b>1961-1967</b>	Buick Green	EP536 .....	\$27.50 ea.	EP536S.....	\$14.00 ea.
<b>1966-1972</b>	Buick Red	EP644 .....	\$27.50 ea.	EP644S.....	\$14.00 ea.

## Cast Iron Paint

Extremely High Temperature - 1800 degrees. Excellent for manifolds and exhaust systems. **Will not burn OFF.**

EP3.....(pint).....\$32.00. ea.  
EP3S.....(spray can).....\$19.50 ea.



## Engine Compartment and Chassis Paint

Our Satin Black Enamel contains the correct blend of dulling agents to give that "Authentic New Look". Use it on inner fender wells, under hood, radiator supports brackets, fan, air cleaner, etc. It is also correct for chassis.

### All Years and Models

EP2.....(quart).....\$24.50 ea.  
EP2S.....(spray can).....\$14.00 ea.

## Spray Gun for Engine Enamels

Self-propelled unit enables you to spray up to 16 oz. of paint. Great for use on engine enamels listed above that are not available in spray cans.

SG220 .....\$8.25 ea.  
Refill cartridge.  
SGR220 .....\$6.50 ea.





D > 56

### Air Cleaner Decals

CARS#	YEARS	APPLICATION	PRICE
D257	1961	Special "185" Tri-Shield (On Snorkel).....	\$5.75
D176	1961-1963	"Buick Skylark" (Silver Ltrs. 7" dia.)...	\$14.25
D175	1961-63	Spec. Fireball V8 (On Snorkel) .....	\$6.00
D272	1962	Special "190" Tri-Shield (On Snorkel).....	\$5.75
D83	1962-1965	"Fireball V6" ( Round ( Blk, Red & Slvr ) .....	\$9.00
D273	1963	Special "200" Tri-Shiel (On Snorkel).....	\$5.75
D352	1964-1965	300 Engine A96C Air Filter Inst.....	\$5.00
D109	1964-1966	"Wildcat 355" ( 7"dia. Red ).....	\$12.75
D159	1964-1966	"Wildcat 310" ( 7" dia. Red ).....	\$14.25
D243	1964-1966	300 Engine Air Filter Instrut. #6421191...\$5.00	
D126	1964-1966	425 engine, 2 X 4BBL (chrome air cleaner) "Super Wildcat".....	\$8.00
D114	1965-1966	GS "Wildcat 445" (14"dia. Red).....	\$15.25
D90	1965	GS AC-A85C ( Filter Instruction).....	\$5.50
D96	1965	A202C decal I.D. #6420861 (Filt. Inst.).....	\$6.25
D354	1966	340-4 Air Cleaner Filter Instr...#6424150 .....	\$3.75
D97	1966	300 Engine Air Filter Instrut. #6421189 .....	\$4.25
D293	1966	"Wildcat 375". 7" diameter.....	\$11.25
D258	1966	SP 310/300 Cu.In. ( Air Clnr. Svce.).....	\$6.25
D353	1966	GS A 85C Air Filter Instruction .....	\$6.00
*D58N	1967-1969	"400-4" ( Red & White ) .....	\$12.75
D58	1967-1969	"400-4" ( Red & White ) .....	\$4.75
*D59N	1968-1969	"GS-400" ( Red & White ).....	\$11.75
D59	1968-1969	"GS-400" ( Red & White ).....	\$5.50
*D47N	1968-1972	"350-2" ( Red & White ) .....	\$9.00
D47	1968-1972	"350-2" ( Red & White ) .....	\$5.00
D-48	1968-1972	350-4" ( 7-1/2" across ) .....	\$5.00
*D49N	1968-1972	"350-4" ( 11" across ) .....	\$11.75
D49	1968-1972	"350-4" ( 11" across ) .....	\$6.00
D56	1968-74	"Keep your GM car" #6424826 .....	\$5.00
*D56N	1968-74	"Keep your GM car" #6424826 .....	\$8.25
D355	1969	GS350 Air Cleaner Instr #6484022 .....	\$4.25
D52	1969-1974	"Stage 1" ( Red & White ).....	\$6.00
D52E	1969-1974	"Stage 1" (Embossed as original) ....	\$8.25
*D53N	1969-1974	"Stage 2" ( Red & White ).....	\$9.75
D53	1969-1974	"Stage 2" ( Red & White ).....	\$6.00
D50	1970-1971	"350-4" HI-COMPRESSION.....	\$6.00
*D50N	1970-1971	"350-4" HI-COMPRESSION.....	\$12.75
D60	1970-1972	"GS-350" ( Red & White ).....	\$5.50
D60E	1970-1972	"GS-350" (Embossed as original) ....	\$8.25
*D60N	1970-1972	"GS-350" (Embossed as original) ..	\$12.75
D54	1970-1974	"455-4" ( Red & White ).....	\$5.00
D51E	1970-1974	"GS-455" (Embossed as original) ....	\$8.50
D51	1970-1974	"GS-455" ( Air Cleaner ).....	\$5.00

**Please Note!** Decal numbers preceded by an asterisk (\*) are NOS! If you have a serious eye for detail, you will surely appreciate the clarity and construction of these originals. Some feature raised print and correct embossing.  
*Quantities are limited.*

### Emissions and Tune-up

CARS#	YEARS	APPLICATION	PRICE
D261	1968	Buick 350-2 ( Automatic Trans ) .....	\$4.75
D262	1968	Buick 350 ( Manual Trans ) .....	\$4.75
D264	1968	Buick 400 ( Manual Trans ) .....	\$4.75
D265	1968	Buick 350-4 ( Auto.Trans ) .....	\$5.00
D266	1969	Buick 350-2 ( Automatic Trans ) .....	\$4.75
D292	1969	350-4 + 400 (Auto Trans).....	\$4.75
D263	1969	Buick 400 ( Manual Trans ) .....	\$4.75
D185	1969	400 (Auto Trans).....	\$4.25
D167	1970	Before 1/1/70 350-2BBL Automatic Transmission .....	\$4.25
D267	1970	Buick 455 STAGE1 (before1/1/70 Manual Transmission) .....	\$5.00
D62	1970	Buick 455 STAGE1 (after1/1/70 Manual Transmission) .....	\$5.50
D102	1970	455 Stage 1 (Automatic Transmission) (after 1/1/70) .....	\$5.50
D168	1970	350-4 BBL (Automatic Trans). .....	\$4.75
D290	1970	455 Stage 1 (Automatic Transmission) (before 1/1/70) .....	\$4.25
D291	1970	350 4BBL (Auto Trans) High Comp .....	\$5.00
D294	1970	All V8 "Evaporative control" decal .....	\$5.00
D309	1970	455 Automatic Transmission .....	\$5.00
D186	1971	350-2 Emissions Decal .....	\$4.75
D268	1971	Buick 350-4 (Automatic Trans) .....	\$6.00
D269	1971	Buick 455 STAGE1 (Automatic/Manual Transmission) .....	\$5.50
D270	1971	Buick GS 455 (Automatic Trans) .....	\$6.00
D278	1972	Buick 350 4BBL (Auto./Manual).....	\$5.75
D120	1972	455 Stage 1 (Auto and Man Trans) .....	\$5.50
D307	1972	All 455.....	\$5.00
D312	1973	All 455.....	\$6.00
D313	1973	All 455 Stage .....	\$6.25
D315	1974	455 4BBL Automatic Trans. .....	\$6.25
D316	1974	455 Stage 1 Automatic Trans. .....	\$6.25



### Valve Cover Decals

CARS#	YEARS	APPLICATION	PRICE
*D87N	1966-1967	"300-2" ( Silver & Black ).....	\$6.75
D87	1966-1967	"300-2" ( Silver & Black ).....	\$5.00
D183	1966-1967	"300 4V" ( Silver & Black ).....	\$5.00
*D88N	1966-1967	"340-2" ( Silver & Black ).....	\$6.75
D88	1966-1967	"340-2" ( Silver & Black ).....	\$5.00
D89	1966-1967	"340-4" ( Silver & Black ).....	\$5.00
D70	1967-1969	"400-4" ( Silver & Black ).....	\$5.00
D67	1968-1974	"350-4" ( Silver & Black ).....	\$5.00
D66	1968-1974	"350-2" ( Silver & Black ).....	\$5.00
D84	1969	"400-4 Stage 1" ( Silver & Black ).....	\$6.25

# Decals • Stickers (Group 0)

## Engine Compartment

CARS#	YEARS	APPLICATION	PRICE
D1	1961-1962	Generator Warning Tag .....	\$2.00
D72	1961-1974	Harrison Air Cond. (Alum. tag).....	\$6.00
D46	1961-1967	"Optikleen" ( Bottle Label ).....	\$3.75
D107	1961-1967	"Optikleen" Bottle cap decal.....	\$4.00
D249	1961-68	Buick GM Wind Wash Klear-View.....	\$4.00
D184	1961-1962	Oil Filler Cap Decal (Orange).....	\$3.00
D172	1961-1963	Air Cond. Compr. Warning.....	\$5.50
D171	1961-1963	Alum. Eng. Cooling .....	\$4.75
D205	1961-1966	"GM" Antifreeze Tag .....	\$4.75
D179	1962-1964	Cooling System Decal.....	\$4.00
D130	1963-1967	"Positive" Battery Warning .....	\$4.50
D63	1968-1974	"Positive " Battery Warning .....	\$4.25
D80	1963-1966	Cooling System Sticker .....	\$4.75
D100	1963-1972	"GM Antifreeze" Sticker.....	\$4.00
D297	1964	Frigidaire Compressor Decal.....	\$5.75
D190	1965	Harrison Air Conditioner Box.....	\$5.00
D187	1965	Frigidaire Air Cond. Compressor.....	\$5.75
D246	1965-1966	Buick Cooling System (X-Flow).....	\$5.50
D122	1965-1966	Downflow Radiator Cooling.....	\$5.00
D251	1966	Frigidaire Air Cond. Compressor.....	\$5.00
D191	1966	Harrison Air Conditioner Box.....	\$5.00
D357	1966-1967	"Canada" Oil Change Decal.....	\$5.50
D192	1967	Harrison Air Conditioner Box.....	\$5.50
D298	1967-1968	Frigidaire Compressor Decal .....	\$5.50
D193	1968	Harrison Air Conditioner Box.....	\$5.00
D358	1968-1969	"Canada" Oil Change Decal #734791 .....	\$5.50
D194	1969	Harrison Air Conditioner Box.....	\$5.00
D252	1969	Frigidaire Air Cond. Compressor.....	\$5.75
D77	1969-1972	Windshield Washer Bottle .....	\$5.50
D195	1970	Harrison Air Conditioner Box.....	\$5.75
D253	1970	Frigidaire Compressor Decal.....	\$5.00
D359	1970-1971	"Canada" Oil Change Decal #733693 .....	\$5.00
D210	1970-1972	Cooling System Decal.....	\$4.25
D188	1971	Frigidaire Air Cond. Compressor.....	\$5.50
D196	1971	Harrison Air Conditioner Box.....	\$5.00
D254	1972	Frigidaire Air Cond. Compressor #5910789 .....	\$4.75
D189	1972	Frigidaire Air Cond. Compressor.....	\$5.75
D197	1972	Harrison Air Conditioner Box.....	\$5.00
D198	1973	Harrison Air Conditioner Box.....	\$5.00
D199	1974	Harrison Air Conditioner Box.....	\$4.25
D200	1975	Harrison Air Conditioner Box.....	\$5.00
D201	1976	Harrison Air Conditioner Box.....	\$4.25



D-55

## Interior

CARS#	YEARS	APPLICATION	PRICE
D44	1961	Glove Box Door Sticker ).....	\$4.75
D166	1961-1962	Sp/Sky Tire and Oil (Glove Box) .....	\$5.00
D165	1961-1962	Glove Box Laquer Paint .....	\$5.50
D71	1961-1963	Casco Automatic Lighter (tag).....	\$4.00
D379	1961-1963	"Air Conditioned" Window Decal .....	\$5.50
D386	1961-1964	Delco Battery Certificate .....	\$4.00
D375	1961-1965	Electric Antenna Tag.....	\$4.75
D371	1964	NEW Car Price Booklet.....	\$4.50
D372	1965	NEW Car Price Booklet.....	\$4.75
D279	1965-1968	Delco Battery Owners Certif.....	\$4.00
D384	1965-1968	Litter Bug Decal.....	\$4.50
D373	1966	NEW Car Price Booklet.....	\$4.75
D95E	1966-1967	"GM mark of Excellence" (Door sticker Aqua/Silver) Embossed .....	\$5.50
D369	1966-1969	NEW Car Factory Build Sheet.....	\$5.50
D91	1967	All Buick Tire Pressure Sticker .....	\$5.50
D271	1968	Special /Skylark Tire Pressure .....	\$5.00
D164	1968	Buick GS 400 Tire Pressure.....	\$5.00
D338	1968	Spec. wagon/Sportwagon Tire Pres.....	\$5.00
D381	1968-1970	Luggage Instruction Tag .....	\$5.50
D55	1968-1974	"GM Mark of Excellence" (Door Sticker Blue/Sliver).....	\$3.75
D55E	1968-1974	"GM Mark of Excellence" (Door Sticker Blue/Sliver) Embossed .....	\$6.50
D339	1969	GS-400 Glove Box Tire Pres. Decal.....	\$5.00
D388	1969-1972	Ignition Lock/Start Sleeve 6" .....	\$5.50
D-389	1969-1972	Ignition Lock/Start Sleeve 7".....	\$4.75
D135	1970	Red Tire Pressure Sticker #1234162.....	\$5.00
D69	1970	Skylark 350 and GS, Green #1234158 Tire Pressure Sticker.....	\$4.75
D300	1970	Skylark 455 and GS 455 Tire Press .....	\$4.75
D374	1971	NEW Car Price Booklet.....	\$4.75
D105	1971	Except GS455 All Tire Pres. Stkr .....	\$5.00
D364	1971	GS455 Glove Box Tire Pressure .....	\$5.00
D380	1971-1973	Starting Instruction Tag .....	\$4.50
D365	1972	GS Glove Box Tire Pressure .....	\$4.75
D239	1972	Sky Seat Belt Installation Sleeve .....	\$4.75
D212	1975-1976	Push Start Warning .....	\$4.25



D276



**Exterior Decals**

CARS #	YEARS	DESCRIPTION	PRICE
D276	1970	"GsX" ( on 1/4 Panel )	\$9.25
D277	1970	"GsX" ( on Rear Spoiler )	\$9.25
D400	1970	Gas Cap Caution Decal (Calif. Cars)	\$5.50
D404	1970-1971	Frame Decal Kit	\$5.00
D163	1973-1974	"gran sport" (Gold 1/4 panel)	\$10.00
D169	1973-1974	"gran sport" (black 1/4 panel)	\$10.00
D303	1973-1974	"gran sport" (white 1/4 panel)	\$11.50
D399		Buick tri-Shield 2 7/8" Wheel Cntr Decal	\$4.75
D405		"Unleaded Fuel Only" 5" Straight-White	\$4.75
D406		"Unleaded Fuel Only" 5" Straight-Black	\$4.75
D407		"Unleaded Fuel Only" 4" Straight-B & W	\$4.75
D408		"Unleaded Fuel Only" 4" Straight-Blk & Slv	\$4.75
D410		"Unleaded Fuel Only" 5" Curved-White	\$4.75
D411		"Unleaded Fuel Only" 5" Curved-Black	\$4.75

**gran sport**

**DECK LID STRIPE KITS**

D241	1973	"Gran Sport" Deck Lid Silver	\$102.50
D240	1973	"Gran Sport" Deck Lid Black	\$109.00
D242	1974	"Gran Sport" Deck Lid Black	\$94.50
D244	1974	"Gran Sport" Deck Lid White	\$102.50



D 108



D 112



D 117



D 111



D310



D 118

**Garage Wall, Tool Box Decals**

D108	Old Style Buick Logo (blue and white)	\$8.50
D111	"Genuine Buick Parts" 2" x 2 1/2" Water Transfer	\$1.50
D112	"Buick 8" 2" x 2 1/2" Water Transfer	\$1.50
D117	"Authorized Service" (10" diameter red, white and blue decal)	\$8.50
D118	"Authorized Service" (5" diameter red, white and blue decal)	\$6.50
D310	Tri-Shield 12" (red, white and blue)	\$9.75

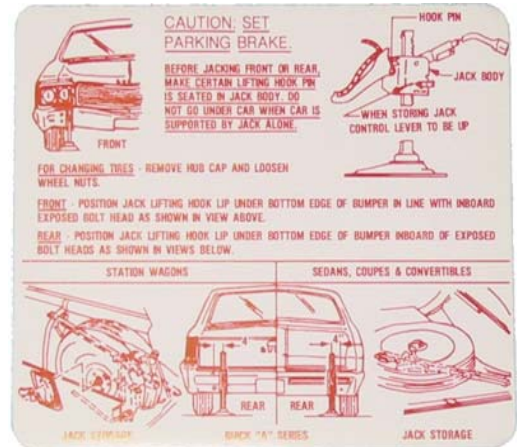

D236

**Trunk**

CARS#	YEARS	APPLICATION	PRICE
D232	1961	Special/Skylark Jack Instr.	\$4.50
D231	1962	Jack Instructions	\$3.00
D132	1963-1964	Jack Instructions	\$5.00
D275	1965	All Jack Instructions	\$4.75
D234	1966	All Jack Instructions	\$4.75
D235	1967	All Jack Instructions	\$4.75
D236	1968-1969	All Jack Instructions	\$4.50
D237	1970	All Jack Instructions	\$4.50
D395	1970-72	Space Save Tire Inflation decal	\$5.50
D238	1971	All Jack Instructions	\$4.75
D396	1971-1973	Canada Limited Slip Decal	\$5.50
D227	1973-1977	Tire Inflator ( On Can )	\$5.00
D304	1972	Skylark/GS Jack Instructions	\$4.75

**NEW Car Window Sticker**

CARS #	YEARS	DESCRIPTION	PRICE
D127	1963-1964	NEW Car Window Sticker	\$5.00
D129	1965-1966	NEW Car Window Sticker	\$5.00
D131	1967	NEW Car Window Sticker	\$5.50
D344	1968	NEW Car Window Sticker	\$5.50
D133	1969-1970	NEW Car Window Sticker	\$5.00
D140	1971-1974	NEW Car Window Sticker	\$5.50

**Please Note!** Decal numbers preceded by an asterisk (\*) are **NOS!** If you have a serious eye for detail, you will surely appreciate the clarity and construction of these originals. Some feature raised print and correct embossing.  
*Quantities are limited.*

## Air Cleaner Identification (Group 0)

---

### 1965-1966 Air Cleaner I.D. Plate.

Not just a "decal", but a high quality silk screened impression on a die cut reflective aluminum disc. Add the final touch to your highly detailed engine compartment. Will not fade or wrinkle. Easy to apply. Absolutely Concourse show quality. Approved and licensed by Buick.



**1965-1966** GS-400 Engines "Buick Wildcat 445"  
14" Diameter.

D114A.....\$37.50 ea.